

LK-Z 045.005.2 BT/...



Description

- concrete recessed housing made from aluminium for fairfaced concrete and concrete with plaster
- end covers, centering and fastening accessories included
- screw fastening of concrete recessed housing on formwork panel

Notes

Required mounting space of concrete recessed housing on formwork is 20 mm surrounding. The linear thermal expansion of the aluminium profile is about 0.3 mm per meter at $\Delta T = 10$ Kelvin.

Dimensions / Weights

| | |
|----------------|---------|
| Width | 67 mm |
| Height | 82 mm |
| Recessed depth | 82 mm |
| Net weight | 1.99 kg |
| Gross weight | 2.01 kg |

Special dimensions

order length of concrete housing = length of empty profile + (2 x 3 mm thickness of end covers) + (2 x 1.5 mm gap) = length of empty profile + 9 mm

| Colours | Article no. | EAN |
|---------|-------------|---------------|
| | 652575 | 4043544612533 |

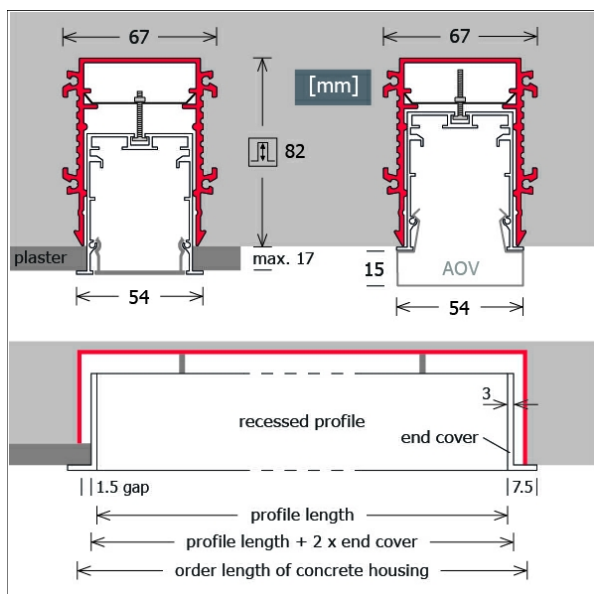

LK-Z 045.005.2 BT/...

Accessories

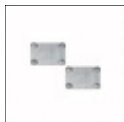

LK-Z 045.005.20
connector kit for concrete housing



LK-Z 045.005.2 BT/...

Light inserts



| Name | Description |
|------------------------|-------------|
| LK-P 045.005.2 AOB/... | |

| Name | Description |
|------------------------|-------------|
| LK-P 045.005.2 APB/... | |
| LK-P 045.005.2 OAG/... | |