

# CSAFL 43.1027.25/DALI

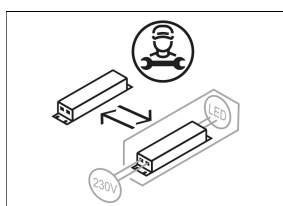

Colours	Article no.	EAN
black	642728	4043544489371
silver	642729	4043544489388
white	642730	4043544489395

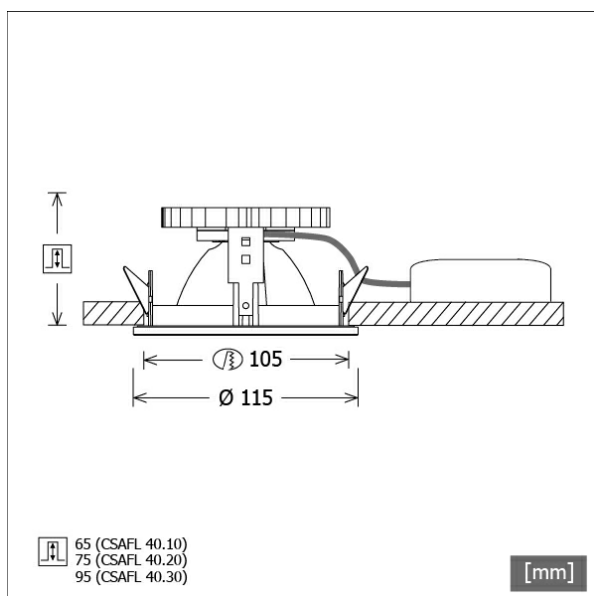

## Description

- recessed downlight with high-gloss front design for wide range of applications
- outstanding ease of maintenance
- no UV and thermal emissions
- thermal management with passive cooling (heat sink made from aluminium)
- specular aluminium reflector with precise symmetrical beam characteristic for high luminous efficiency and glare-free lighting
- front ring and recessed ring made from die-cast zinc
- tool-free ceiling mounting via leaf springs (adjustable ceiling thickness)
- luminaire and ballast permanently connected via cable (length: 500 mm), ballast ready for mains connection
- ballast (LED converter DALI, dimmable) included (external placement)

## Standard options



## Special options



## Lighting data / Norms

<b>Lamps</b>	LED Spot / CRI 80 / 2700 K
<b>EPREL light sources</b>	848120
	L90 B50 50.000 h
	L80 B50 100.000 h
	L80 B20 50.000 h
<b>Lifetime</b>	
<b>System power</b>	14.0 W
<b>Luminaire luminous flux</b>	1360 lm
<b>System efficiency</b>	97.14 lm/W
<b>Module efficiency</b>	127.18 lm/W
<b>UGR class</b>	≤19
<b>Beam range</b>	Medium Flood
<b>Beam angle</b>	23°
<b>Supply voltage</b>	220 - 240 V / 50 - 60 Hz
<b>Protection class</b>	II
<b>Type of protection</b>	IP20

## Dimensions / Weights

<b>Outer diameter</b>	115 mm
<b>Height</b>	70 mm
<b>Cut-out (Ø)</b>	105 mm
<b>Ceiling thickness</b>	3.0 - 25.0 mm
<b>Recessed depth</b>	65 mm
<b>Net weight</b>	0.65 kg
<b>Gross weight</b>	0.72 kg

# CSAFL 43.1027.25/DALI

CSA 40 Flat (1xLED 14W 827/2700K 1370lm 15 °)

C0/C180 cd / 1000 lm

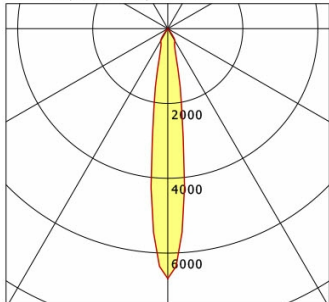

	C0	C90	C180	C270
0°	6680	6680	6680	6680
15°	959	959	959	959
30°	381	381	381	381
45°	4	4	4	4
60°	3	3	3	3
75°	2	2	2	2
90°	0	0	0	0
cd / 1000 lm				

Offset [m] Cone width [m] Illuminance [lx]

C0-C180 Plane		
3.0	0.77	1016.8
6.0	1.54	254.2
9.0	2.31	113.0
12.0	3.08	63.6
15.0	3.85	40.7

<b>η</b>	LED
Efficiency	98 lm/W
Direct/Indirect	↓ 100% / ↑ 0%
System Power	14 W
<b>UGR</b>	X=4H, Y=8H
Reflection factors	70/50/20
UGR C0/C180	16.5
UGR C90/C270	16.5
CIE Flux Codes	99 99 100 100 100
Ra/CRI	>80

LTS

## Accessories



**ZB-OR DONGLE**  
Organic Response IR dongle kit



**ZB-OR GATEWAY**  
Organic Response IoT Gateway Cascade Series



**ZB-OR-R SENSOR**  
Organic Response sensor for recessed mounting