

CSAFL 43.2030.35/DALI

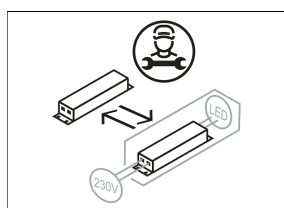

| Colours | Article no. | EAN |
|---------|-------------|---------------|
| black | 642779 | 4043544489883 |
| silver | 642780 | 4043544489890 |
| white | 642781 | 4043544489906 |

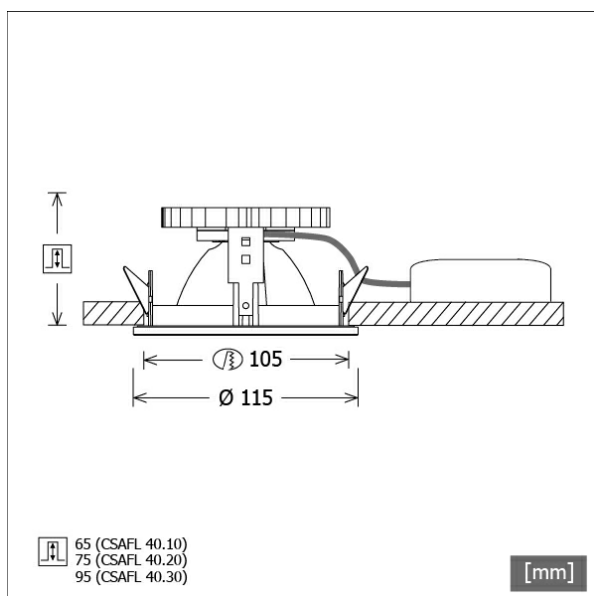

Description

- recessed downlight with high-gloss front design for wide range of applications
- outstanding ease of maintenance
- no UV and thermal emissions
- thermal management with passive cooling (heat sink made from aluminium)
- specular aluminium reflector with precise symmetrical beam characteristic for high luminous efficiency and glare-free lighting
- front ring and recessed ring made from die-cast zinc
- tool-free ceiling mounting via leaf springs (adjustable ceiling thickness)
- luminaire and ballast permanently connected via cable (length: 500 mm), ballast ready for mains connection
- ballast (LED converter DALI, dimmable) included (external placement)

Standard options

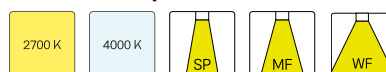

Special options

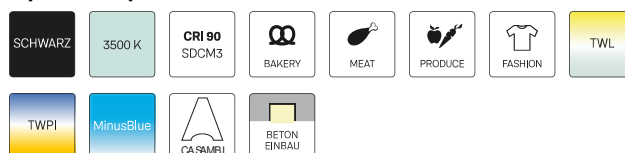

Lighting data / Norms

| | |
|--------------------------------|----------------------------|
| Lamps | LED Spot / CRI 80 / 3000 K |
| EPREL light sources | 848117 |
| | L90 B50 50.000 h |
| | L80 B50 100.000 h |
| | L80 B20 50.000 h |
| Lifetime | |
| System power | 27.0 W |
| Luminaire luminous flux | 2710 lm |
| System efficiency | 100.37 lm/W |
| Module efficiency | 156.64 lm/W |
| UGR class | ≤22 |
| Beam range | Flood |
| Beam angle | 36° |
| Supply voltage | 220 - 240 V / 50 - 60 Hz |
| Protection class | II |
| Type of protection | IP20 |

Dimensions / Weights

| | |
|--------------------------|---------------|
| Outer diameter | 115 mm |
| Height | 80 mm |
| Cut-out (Ø) | 105 mm |
| Ceiling thickness | 3.0 - 25.0 mm |
| Recessed depth | 75 mm |
| Net weight | 0.72 kg |
| Gross weight | 0.80 kg |

CSAFL 43.2030.35/DALI

CSA 40 Flat (1xLED 27W 830/3000K 2710lm 35 °)

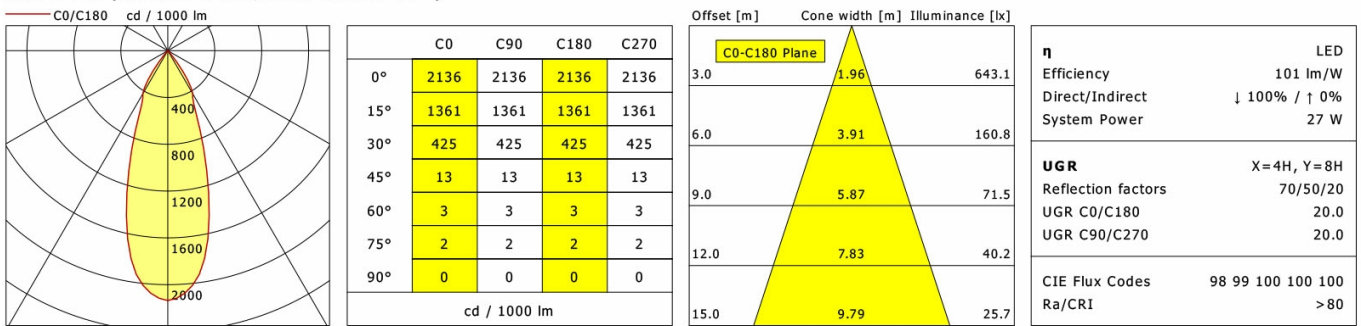

Accessories



ZB-OR DONGLE
Organic Response IR dongle kit



ZB-OR GATEWAY
Organic Response IoT Gateway Cascade Series



ZB-OR-R SENSOR
Organic Response sensor for recessed mounting