

# CSAFL 43.3030.50/DALI

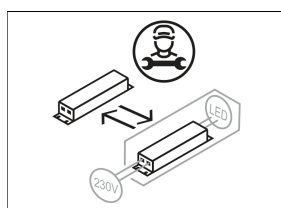

Colours	Article no.	EAN
black	642818	4043544490278
silver	642819	4043544490285
white	642820	4043544490292

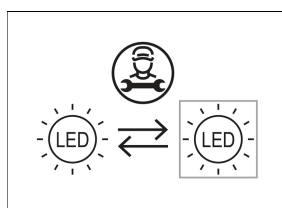
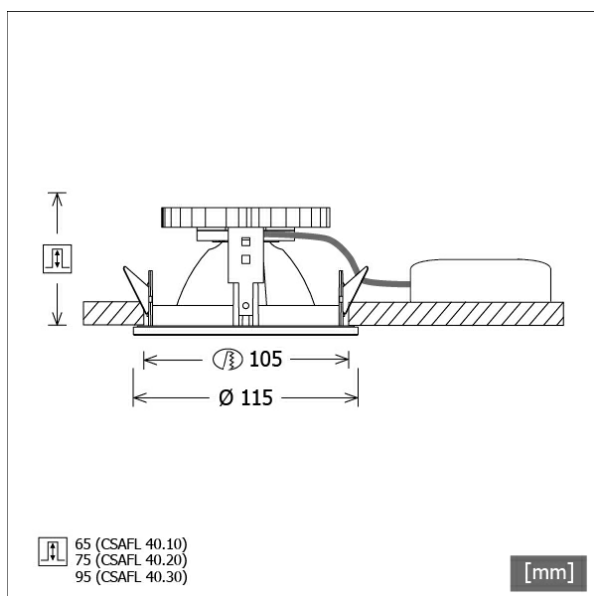

## Description

- recessed downlight with high-gloss front design for wide range of applications
- outstanding ease of maintenance
- no UV and thermal emissions
- thermal management with passive cooling (heat sink made from aluminium)
- specular aluminium reflector with precise symmetrical beam characteristic for high luminous efficiency and glare-free lighting
- front ring and recessed ring made from die-cast zinc
- tool-free ceiling mounting via leaf springs (adjustable ceiling thickness)
- luminaire and ballast permanently connected via cable (length: 500 mm), ballast ready for mains connection
- ballast (LED converter DALI, dimmable) included (external placement)

## Standard options

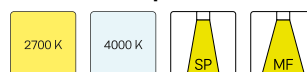

## Special options

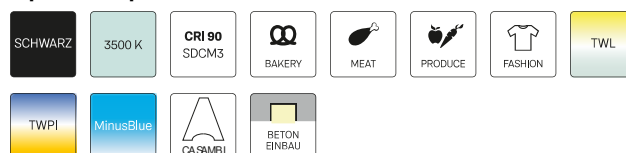

## Lighting data / Norms

<b>Lamps</b>	LED Spot / CRI 80 / 3000 K
<b>EPREL light sources</b>	851239
<b>Lifetime</b>	L90 B50 50.000 h L80 B50 100.000 h L80 B20 50.000 h
<b>System power</b>	36.0 W
<b>Luminaire luminous flux</b>	3530 lm
<b>System efficiency</b>	98.05 lm/W
<b>Module efficiency</b>	158.91 lm/W
<b>UGR class</b>	≤22
<b>Beam range</b>	Wide Flood
<b>Beam angle</b>	46°
<b>Supply voltage</b>	220 - 240 V / 50 - 60 Hz
<b>Protection class</b>	II
<b>Type of protection</b>	IP20

## Dimensions / Weights

<b>Outer diameter</b>	115 mm
<b>Height</b>	100 mm
<b>Cut-out (Ø)</b>	105 mm
<b>Ceiling thickness</b>	3.0 - 25.0 mm
<b>Recessed depth</b>	95 mm
<b>Net weight</b>	0.84 kg
<b>Gross weight</b>	0.92 kg

# CSAFL 43.3030.50/DALI

CSA 40 Flat (1xLED 36W 830/3000K 3530lm 50 °)

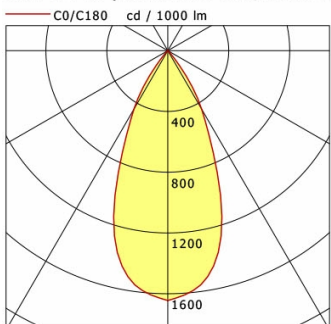

	C0	C90	C180	C270
0°	1645	1645	1645	1645
15°	1322	1322	1322	1322
30°	444	444	444	444
45°	14	14	14	14
60°	4	4	4	4
75°	4	4	4	4
90°	0	0	0	0
cd / 1000 lm				

Offset [m]	Cone width [m]	Illuminance [lx]
C0-C180 Plane		
3.0	2.51	645.1
6.0	5.01	161.3
9.0	7.52	71.7
12.0	10.02	40.3
15.0	12.53	25.8

<b>η</b>	LED
Efficiency	98 lm/W
Direct/Indirect	↓ 100% / ↑ 0%
System Power	36 W
<b>UGR</b>	X=4H, Y=8H
Reflection factors	70/50/20
UGR C0/C180	20.9
UGR C90/C270	20.9
CIE Flux Codes	98 99 100 100 100
Ra/CRI	>80

LTS

## Accessories



**ZB-OR DONGLE**  
Organic Response IR dongle kit



**ZB-OR GATEWAY**  
Organic Response IoT Gateway Cascade Series



**ZB-OR-R SENSOR**  
Organic Response sensor for recessed mounting