

ORYO-T 101.940.15



Description

- flexible filigree track-mounted spotlight with slightly conical light-head
- light-head rotates through 355° and pivots through 90° via integrated articulated arm
- outstanding ease of maintenance
- no UV and thermal emissions
- anti-glare shield and decorative anti-glare ring available as accessories
- light-head made from die-cast aluminium
- innovative thermal management with design-integrated passive cooling
- high performance specular aluminium reflector with precise symmetrical beam characteristic for high luminous efficiency and glare-free lighting
- black internal thermoplastic front ring
- clear acrylic safety glass
- 3-phase track adapter with integrated ballast

Notes

Not compatible with ONETrack Trimless tracks.

Standard options



Special options



Lighting data / Norms

| | |
|-------------------------|---|
| Lamps | LED Spot / CRI 90 / 4000 K |
| EPREL light sources | 854615 |
| Lifetime | L90 B50 50.000 h L80 B50 100.000 h L80 B20 50.000 h |
| System power | 18.0 W |
| Luminaire luminous flux | 1460 lm |
| System efficiency | 81.11 lm/W |
| Module efficiency | 136.36 lm/W |
| UGR class | ≤22 |
| Beam range | Spot |
| Beam angle | 15° |
| Supply voltage | 220 - 240 V / 50 - 60 Hz |
| Protection class | II |
| Type of protection | IP20 |

Dimensions / Weights

| | |
|------------------------|---------|
| Length | 231 mm |
| Width | 66 mm |
| Height | 96 mm |
| Diameter of light head | 66 mm |
| Net weight | 0.46 kg |
| Gross weight | 0.56 kg |

| Colours | Article no. | EAN |
|---------|-------------|---------------|
| black | 664044 | 4043544731760 |
| white | 664045 | 4043544731777 |
| silver | 664521 | 4043544736567 |

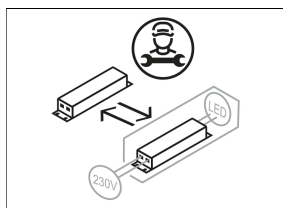
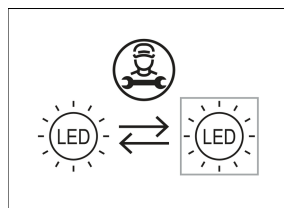
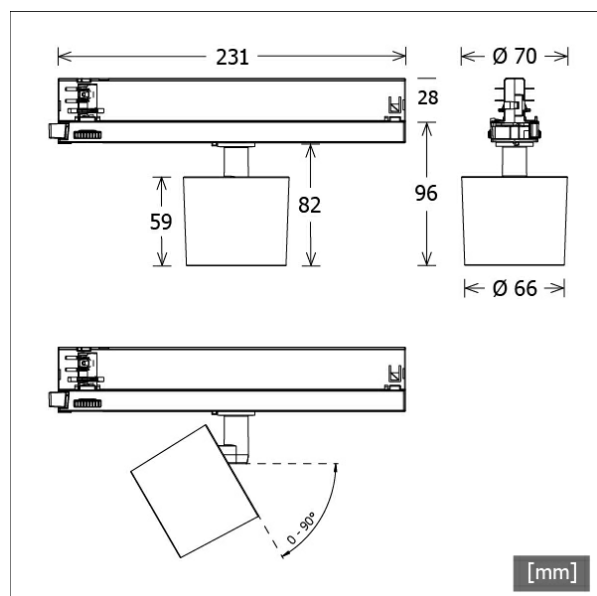

ORYO-T 101.940.15

Oryo 100 | Track-Mounted (1xLED 18W 940/4000K 1460lm 15°)

C0/C180 cd / 1000 lm

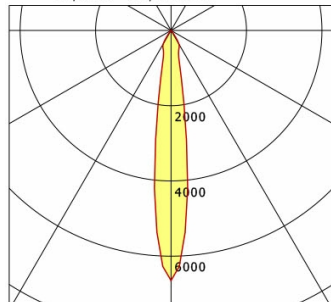

| | C0 | C90 | C180 | C270 |
|--------------|------|------|------|------|
| 0° | 6647 | 6647 | 6647 | 6647 |
| 15° | 829 | 829 | 829 | 829 |
| 30° | 416 | 416 | 416 | 416 |
| 45° | 15 | 15 | 15 | 15 |
| 60° | 12 | 12 | 12 | 12 |
| 75° | 1 | 1 | 1 | 1 |
| 90° | 0 | 0 | 0 | 0 |
| cd / 1000 lm | | | | |

Offset [m] Cone width [m] Illuminance [lx]

| C0-C180 Plane | | |
|---------------|------|--------|
| 3.0 | 0.77 | 1078.2 |
| 6.0 | 1.55 | 269.6 |
| 9.0 | 2.32 | 119.8 |
| 12.0 | 3.09 | 67.4 |
| 15.0 | 3.86 | 43.1 |

| | |
|--------------------|--------------------|
| η | LED |
| Efficiency | 81 lm/W |
| Direct/Indirect | ↓ 100% / ↑ 0% |
| System Power | 18 W |
| UGR | X=4H, Y=8H |
| Reflection factors | 70/50/20 |
| UGR C0/C180 | 19.5 |
| UGR C90/C270 | 19.5 |
| CIE Flux Codes | 97 100 100 100 100 |
| Ra/CRI | >90 |

LTS

Accessories



ST-A 10/9000A-1-ST
 surface-mounted track ONETrack Advance with data bus
 (length: 1000 mm)



ST-A 20/9000A-2-ST
 surface-mounted track ONETrack Advance with data bus
 (length: 2000 mm)



ST-A 30/9000A-3-ST
 surface-mounted track ONETrack Advance with data bus
 (length: 3000 mm)



ST-A 40/9000A-4-ST
 surface-mounted track ONETrack Advance with data bus
 (length: 4000 mm)



ST-E 10/9000-1-R
 recessed track ONETrack with data bus
 (length: 1000 mm)



ST-E 20/9000-2-R
 recessed track ONETrack with data bus
 (length: 2000 mm)



ST-E 30/9000-3-R
 recessed track ONETrack with data bus
 (length: 3000 mm)



ST-E 40/9000-4-R
 recessed track ONETrack with data bus
 (length: 4000 mm)



ZB-AGS 001
 anti-glare shield



ZB-DAR 001
 decorative anti-glare ring



ZBW 88
 honeycomb louvre