

## ORYO-T 101.940.25



## Description

- flexible filigree track-mounted spotlight with slightly conical light-head
- light-head rotates through 355° and pivots through 90° via integrated articulated arm
- outstanding ease of maintenance
- no UV and thermal emissions
- anti-glare shield and decorative anti-glare ring available as accessories
- light-head made from die-cast aluminium
- innovative thermal management with design-integrated passive cooling
- high performance specular aluminium reflector with precise symmetrical beam characteristic for high luminous efficiency and glare-free lighting
- black internal thermoplastic front ring
- clear acrylic safety glass
- 3-phase track adapter with integrated ballast

## Notes

Not compatible with ONETrack Trimless tracks.

## Standard options



## Special options

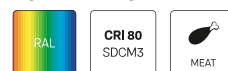

## Lighting data / Norms

Lamps	LED Spot / CRI 90 / 4000 K
EPREL light sources	854571
Lifetime	L90 B50 50.000 h L80 B50 100.000 h L80 B20 50.000 h
System power	20.0 W
Luminaire luminous flux	1820 lm
System efficiency	91.00 lm/W
Module efficiency	140.95 lm/W
UGR class	≤19
Beam range	Medium Flood
Beam angle	30°
Supply voltage	220 - 240 V / 50 - 60 Hz
Protection class	II
Type of protection	IP20

## Dimensions / Weights

Length	231 mm
Width	66 mm
Height	96 mm
Diameter of light head	66 mm
Net weight	0.46 kg
Gross weight	0.56 kg

Colours	Article no.	EAN
black	664048	4043544731807
white	664049	4043544731814
silver	664523	4043544736581

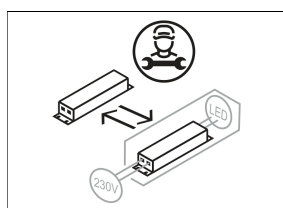
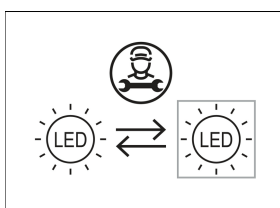
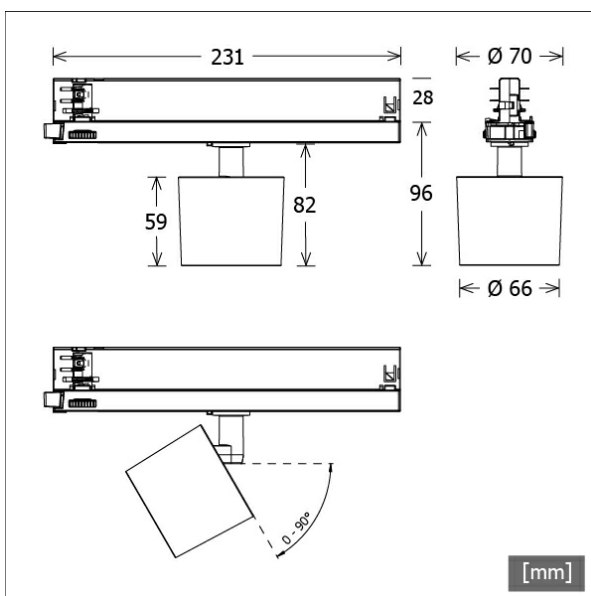

# ORYO-T 101.940.25

Oryo 100 | Track-Mounted (1xLED 20W 940/4000K 1820lm 25°)

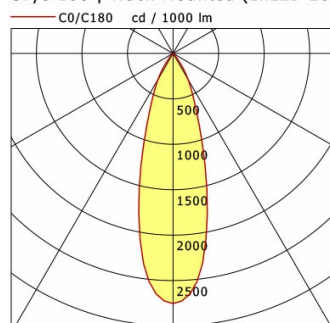

	C0	C90	C180	C270
0°	2753	2753	2753	2753
15°	1403	1403	1403	1403
30°	332	332	332	332
45°	17	17	17	17
60°	7	7	7	7
75°	2	2	2	2
90°	0	0	0	0
cd / 1000 lm				

Offset [m]	Cone width [m]	Illuminance [lx]
3.0	1.63	556.7
6.0	3.26	139.2
9.0	4.89	61.9
12.0	6.53	34.8
15.0	8.16	22.3

C0-C180 Plane

<b>η</b>	LED
Efficiency	91 lm/W
Direct/Indirect	↓ 100% / ↑ 0%
System Power	20 W
<b>UGR</b>	X=4H, Y=8H
Reflection factors	70/50/20
UGR C0/C180	19.4
UGR C90/C270	19.4
CIE Flux Codes	97 99 100 100 100
Ra/CRI	>90

LTS

## Accessories



**ST-A 10/9000A-1-ST**  
 surface-mounted track ONETrack Advance with data bus  
 (length: 1000 mm)



**ST-A 20/9000A-2-ST**  
 surface-mounted track ONETrack Advance with data bus  
 (length: 2000 mm)



**ST-A 30/9000A-3-ST**  
 surface-mounted track ONETrack Advance with data bus  
 (length: 3000 mm)



**ST-A 40/9000A-4-ST**  
 surface-mounted track ONETrack Advance with data bus  
 (length: 4000 mm)



**ST-E 10/9000-1-R**  
 recessed track ONETrack with data bus  
 (length: 1000 mm)



**ST-E 20/9000-2-R**  
 recessed track ONETrack with data bus  
 (length: 2000 mm)



**ST-E 30/9000-3-R**  
 recessed track ONETrack with data bus  
 (length: 3000 mm)



**ST-E 40/9000-4-R**  
 recessed track ONETrack with data bus  
 (length: 4000 mm)



**ZB-AGS 001**  
 anti-glare shield



**ZB-DAR 001**  
 decorative anti-glare ring



**ZBW 88**  
 honeycomb louvre