

ORYO-T 101.940.45/DALI-ST



Description

- flexible filigree track-mounted spotlight with slightly conical light-head
- light-head rotates through 355° and pivots through 90° via integrated articulated arm
- outstanding ease of maintenance
- no UV and thermal emissions
- anti-glare shield and decorative anti-glare ring available as accessories
- light-head made from die-cast aluminium
- innovative thermal management with design-integrated passive cooling
- high performance specular aluminium reflector with precise symmetrical beam characteristic for high luminous efficiency and glare-free lighting
- black internal thermoplastic front ring
- clear acrylic safety glass
- 3-phase track adapter (ONETrack) with integrated DALI ballast

Notes

Compatible with power tracks ONETrack and Global Trac PULSE. Not compatible with ONETrack Trimless tracks.

Colours	Article no.	EAN
black	664054	4043544731869
white	664055	4043544731876
silver	664526	4043544736611

Standard options



Lighting data / Norms

Lamps	LED Spot / CRI 90 / 4000 K
EPREL light sources	854571
Lifetime	L90 B50 50.000 h L80 B50 100.000 h L80 B20 50.000 h
System power	20.0 W
Luminaire luminous flux	1940 lm
System efficiency	97.00 lm/W
Module efficiency	140.95 lm/W
UGR class	≤22
Beam range	Wide Flood
Beam angle	46°
Supply voltage	220 - 240 V / 50 - 60 Hz
Protection class	II
Type of protection	IP20

Dimensions / Weights

Length	260 mm
Width	66 mm
Height	96 mm
Diameter of light head	66 mm
Net weight	0.46 kg
Gross weight	0.56 kg

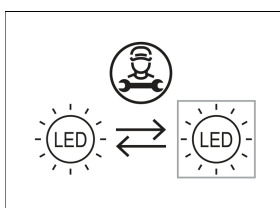
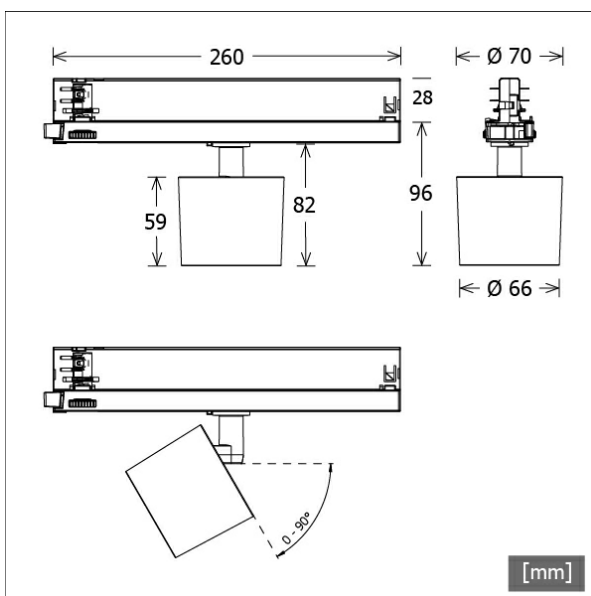

ORYO-T 101.940.45/DALI-ST

Oryo 100 | Track-Mounted (1xLED 20W 940/4000K 1940lm 45°)

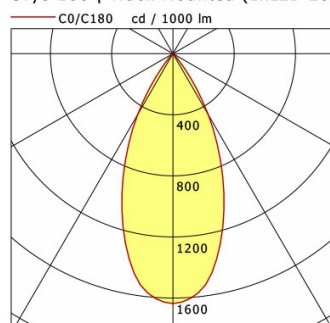

	C0	C90	C180	C270
0°	1636	1636	1636	1636
15°	1232	1232	1232	1232
30°	461	461	461	461
45°	24	24	24	24
60°	8	8	8	8
75°	2	2	2	2
90°	0	0	0	0

cd / 1000 lm

Offset [m]	Cone width [m]	Illuminance [lx]
3.0	2.54	352.6
6.0	5.08	88.2
9.0	7.62	39.2
12.0	10.16	22.0
15.0	12.70	14.1

C0-C180 Plane

η	LED
Efficiency	97 lm/W
Direct/Indirect	↓ 100% / ↑ 0%
System Power	20 W
UGR	X=4H, Y=8H
Reflection factors	70/50/20
UGR C0/C180	21.7
UGR C90/C270	21.7
CIE Flux Codes	96 99 100 100 100
Ra/CRI	>90

LTS

Accessories



ST-A 10/9000A-1-ST
 surface-mounted track ONETrack Advance with data bus
 (length: 1000 mm)



ST-A 20/9000A-2-ST
 surface-mounted track ONETrack Advance with data bus
 (length: 2000 mm)



ST-A 30/9000A-3-ST
 surface-mounted track ONETrack Advance with data bus
 (length: 3000 mm)



ST-A 40/9000A-4-ST
 surface-mounted track ONETrack Advance with data bus
 (length: 4000 mm)



ST-E 10/9000-1-R
 recessed track ONETrack with data bus
 (length: 1000 mm)



ST-E 20/9000-2-R
 recessed track ONETrack with data bus
 (length: 2000 mm)



ST-E 30/9000-3-R
 recessed track ONETrack with data bus
 (length: 3000 mm)



ST-E 40/9000-4-R
 recessed track ONETrack with data bus
 (length: 4000 mm)



ZB-AGS 001
 anti-glare shield



ZB-DAR 001
 decorative anti-glare ring



ZB-OR DONGLE
 Organic Response IR dongle kit



ZB-OR GATEWAY
 Organic Response IoT Gateway Cascade Series

Track-Mounted Spotlights · ORYO 100 Track-Mounted



ORYO-T 101.940.45/DALI-ST

Accessories



ZB-OR-T SENSOR
Organic Response sensor for track mounting



ZBW 88
honeycomb louvre