

ORYO-T 203.940.15



Description

- flexible track-mounted spotlight with slightly conical light-head
- light-head rotates through 355° and pivots through 90° via integrated articulated arm
- outstanding ease of maintenance
- no UV and thermal emissions
- anti-glare shield and decorative anti-glare ring available as accessories
- light-head made from die-cast aluminium
- innovative thermal management with design-integrated passive cooling
- high performance specular aluminium reflector with precise symmetrical beam characteristic for high luminous efficiency and glare-free lighting
- black internal thermoplastic front ring
- clear safety glass
- 3-phase track adapter with integrated ballast

Notes

Not compatible with ONETrack Trimless tracks.

Standard options



Special options



Lighting data / Norms

| | |
|-------------------------|---|
| Lamps | LED Spot / CRI 90 / 4000 K |
| EPREL light sources | 854571 |
| Lifetime | L90 B50 50.000 h L80 B50 100.000 h L80 B20 50.000 h |
| System power | 30.0 W |
| Luminaire luminous flux | 3080 lm |
| System efficiency | 102.66 lm/W |
| Module efficiency | 140.95 lm/W |
| UGR class | ≤19 |
| Beam range | Spot |
| Beam angle | 18° |
| Supply voltage | 220 - 240 V / 50 - 60 Hz |
| Protection class | II |
| Type of protection | IP20 |

Dimensions / Weights

| | |
|------------------------|---------|
| Length | 231 mm |
| Width | 85 mm |
| Height | 108 mm |
| Diameter of light head | 85 mm |
| Net weight | 0.68 kg |
| Gross weight | 0.78 kg |

| Colours | Article no. | EAN |
|---------|-------------|---------------|
| black | 664154 | 4043544732866 |
| white | 664155 | 4043544732873 |
| silver | 664629 | 4043544737649 |

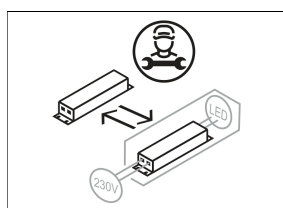
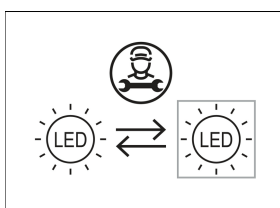
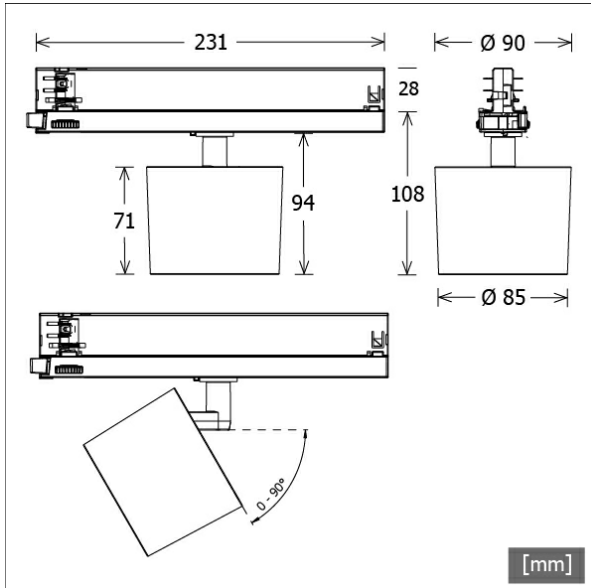

ORYO-T 203.940.15

Oryo 200 | Track-Mounted (1xLED 30W 940/4000K 3080lm 15°)

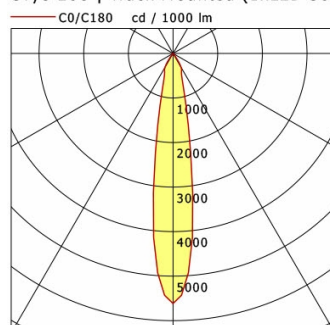

| | C0 | C90 | C180 | C270 |
|--------------|------|------|------|------|
| 0° | 5615 | 5615 | 5615 | 5615 |
| 15° | 1034 | 1034 | 1034 | 1034 |
| 30° | 365 | 365 | 365 | 365 |
| 45° | 10 | 10 | 10 | 10 |
| 60° | 9 | 9 | 9 | 9 |
| 75° | 0 | 0 | 0 | 0 |
| 90° | 0 | 0 | 0 | 0 |
| cd / 1000 lm | | | | |

| Offset [m] | Cone width [m] | Illuminance [lx] |
|------------|----------------|------------------|
| 3.0 | 0.95 | 1921.5 |
| 6.0 | 1.86 | 480.4 |
| 9.0 | 2.79 | 213.5 |
| 12.0 | 3.72 | 120.1 |
| 15.0 | 4.65 | 76.9 |

| | |
|--------------------|--------------------|
| η | LED |
| Efficiency | 103 lm/W |
| Direct/Indirect | ↓ 100% / ↑ 0% |
| System Power | 30 W |
| UGR | X=4H, Y=8H |
| Reflection factors | 70/50/20 |
| UGR C0/C180 | 19.0 |
| UGR C90/C270 | 19.0 |
| CIE Flux Codes | 98 100 100 100 100 |
| Ra/CRI | >90 |

LTS

Accessories



ST-A 10/9000A-1-ST
 surface-mounted track ONETrack Advance with data bus
 (length: 1000 mm)



ST-A 20/9000A-2-ST
 surface-mounted track ONETrack Advance with data bus
 (length: 2000 mm)



ST-A 30/9000A-3-ST
 surface-mounted track ONETrack Advance with data bus
 (length: 3000 mm)



ST-A 40/9000A-4-ST
 surface-mounted track ONETrack Advance with data bus
 (length: 4000 mm)



ST-E 10/9000-1-R
 recessed track ONETrack with data bus
 (length: 1000 mm)



ST-E 20/9000-2-R
 recessed track ONETrack with data bus
 (length: 2000 mm)



ST-E 30/9000-3-R
 recessed track ONETrack with data bus
 (length: 3000 mm)



ST-E 40/9000-4-R
 recessed track ONETrack with data bus
 (length: 4000 mm)



ZB-AGS 002
 anti-glare shield



ZB-DAR 002
 decorative anti-glare ring



ZBW 89
 honeycomb louvre