

ORYO-T 203.940.45



Description

- flexible track-mounted spotlight with slightly conical light-head
- light-head rotates through 355° and pivots through 90° via integrated articulated arm
- outstanding ease of maintenance
- no UV and thermal emissions
- anti-glare shield and decorative anti-glare ring available as accessories
- light-head made from die-cast aluminium
- innovative thermal management with design-integrated passive cooling
- high performance specular aluminium reflector with precise symmetrical beam characteristic for high luminous efficiency and glare-free lighting
- black internal thermoplastic front ring
- clear safety glass
- 3-phase track adapter with integrated ballast

Notes

Not compatible with ONETrack Trimless tracks.

Standard options



Special options

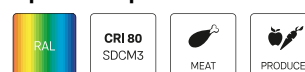

Lighting data / Norms

Lamps	LED Spot / CRI 90 / 4000 K
EPREL light sources	847894
Lifetime	L90 B50 50.000 h L80 B50 100.000 h L80 B20 50.000 h
System power	30.0 W
Luminaire luminous flux	3520 lm
System efficiency	117.33 lm/W
Module efficiency	149.15 lm/W
UGR class	≤22
Beam range	Flood
Beam angle	45°
Supply voltage	220 - 240 V / 50 - 60 Hz
Protection class	II
Type of protection	IP20

Dimensions / Weights

Length	231 mm
Width	85 mm
Height	108 mm
Diameter of light head	85 mm
Net weight	0.68 kg
Gross weight	0.78 kg

Colours	Article no.	EAN
black	664162	4043544732941
white	664163	4043544732958
silver	664633	4043544737687

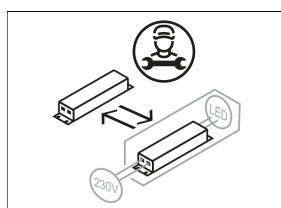
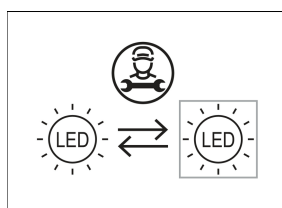
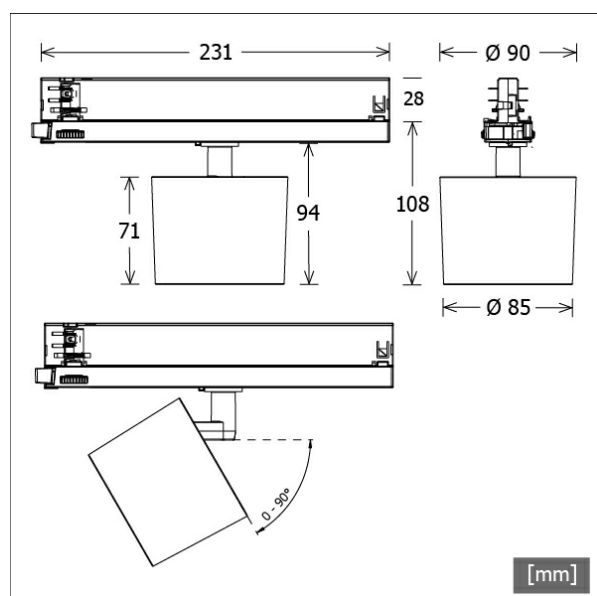

ORYO-T 203.940.45

Oryo 200 | Track-Mounted (1xLED 30W 940/4000K 3520lm 45°)

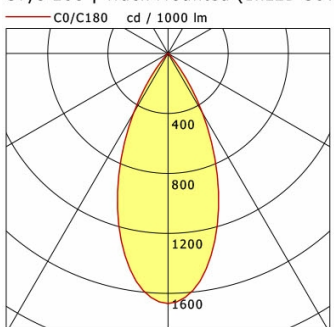

	C0	C90	C180	C270
0°	1668	1668	1668	1668
15°	1239	1239	1239	1239
30°	457	457	457	457
45°	21	21	21	21
60°	6	6	6	6
75°	2	2	2	2
90°	0	0	0	0
cd / 1000 lm				

Offset [m]	Cone width [m]	Illuminance [lx]
3.0	2.52	652.2
6.0	5.03	163.1
9.0	7.55	72.5
12.0	10.06	40.8
15.0	12.58	26.1

η	LED
Efficiency	117 lm/W
Direct/Indirect	↓ 100% / ↑ 0%
System Power	30 W
UGR	X=4H, Y=8H
Reflection factors	70/50/20
UGR C0/C180	21.5
UGR C90/C270	21.5
CIE Flux Codes	97 99 100 100 100
Ra/CRI	> 90

LTS

Accessories



ST-A 10/9000A-1-ST
surface-mounted track ONETrack Advance with data bus
(length: 1000 mm)



ST-A 20/9000A-2-ST
surface-mounted track ONETrack Advance with data bus
(length: 2000 mm)



ST-A 30/9000A-3-ST
surface-mounted track ONETrack Advance with data bus
(length: 3000 mm)



ST-A 40/9000A-4-ST
surface-mounted track ONETrack Advance with data bus
(length: 4000 mm)



ST-E 10/9000-1-R
recessed track ONETrack with data bus
(length: 1000 mm)



ST-E 20/9000-2-R
recessed track ONETrack with data bus
(length: 2000 mm)



ST-E 30/9000-3-R
recessed track ONETrack with data bus
(length: 3000 mm)



ST-E 40/9000-4-R
recessed track ONETrack with data bus
(length: 4000 mm)



ZB-AGS 002
anti-glare shield



ZB-DAR 002
decorative anti-glare ring



ZBW 89
honeycomb louvre