

ORYO-T 203.940.45/DALI-ST



Description

- flexible track-mounted spotlight with slightly conical light-head
- light-head rotates through 355° and pivots through 90° via integrated articulated arm
- outstanding ease of maintenance
- no UV and thermal emissions
- anti-glare shield and decorative anti-glare ring available as accessories
- light-head made from die-cast aluminium
- innovative thermal management with design-integrated passive cooling
- high performance specular aluminium reflector with precise symmetrical beam characteristic for high luminous efficiency and glare-free lighting
- black internal thermoplastic front ring
- clear safety glass
- 3-phase track adapter (ONETrack) with integrated DALI ballast

Notes

Compatible with power tracks ONETrack and Global Trac PULSE. Not compatible with ONETrack Trimless tracks.

Colours	Article no.	EAN
black	664164	4043544732965
white	664165	4043544732972
silver	664634	4043544737694

Standard options



Lighting data / Norms

Lamps	LED Spot / CRI 90 / 4000 K
EPREL light sources	847894
Lifetime	L90 B50 50.000 h L80 B50 100.000 h L80 B20 50.000 h
System power	30.0 W
Luminaire luminous flux	3520 lm
System efficiency	117.33 lm/W
Module efficiency	149.15 lm/W
UGR class	≤22
Beam angle	45°
Supply voltage	220 - 240 V / 50 - 60 Hz
Protection class	II
Type of protection	IP20

Dimensions / Weights

Length	260 mm
Width	85 mm
Height	108 mm
Diameter of light head	85 mm
Net weight	0.68 kg
Gross weight	0.78 kg

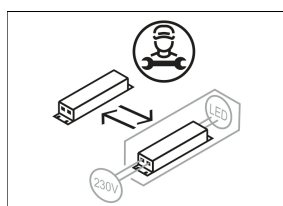
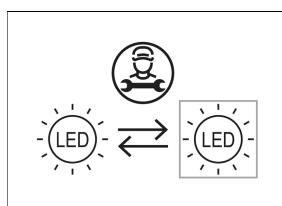
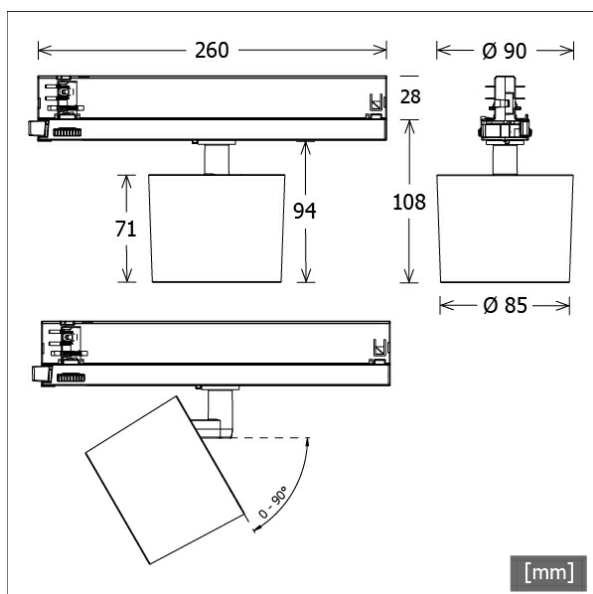

ORYO-T 203.940.45/DALI-ST

Oryo 200 | Track-Mounted (1xLED 30W 940/4000K 3520lm 45°)

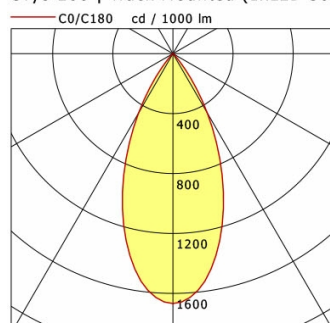

	C0	C90	C180	C270
0°	1668	1668	1668	1668
15°	1239	1239	1239	1239
30°	457	457	457	457
45°	21	21	21	21
60°	6	6	6	6
75°	2	2	2	2
90°	0	0	0	0

cd / 1000 lm

Offset [m]	Cone width [m]	Illuminance [lx]
3.0	2.52	652.2
6.0	5.03	163.1
9.0	7.55	72.5
12.0	10.06	40.8
15.0	12.58	26.1

C0-C180 Plane

η	LED
Efficiency	117 lm/W
Direct/Indirect	↓ 100% / ↑ 0%
System Power	30 W
UGR	X=4H, Y=8H
Reflection factors	70/50/20
UGR C0/C180	21.5
UGR C90/C270	21.5
CIE Flux Codes	97 99 100 100 100
Ra/CRI	>90

LTS

Accessories



ST-A 10/9000A-1-ST
 surface-mounted track ONETrack Advance with data bus
 (length: 1000 mm)



ST-A 20/9000A-2-ST
 surface-mounted track ONETrack Advance with data bus
 (length: 2000 mm)



ST-A 30/9000A-3-ST
 surface-mounted track ONETrack Advance with data bus
 (length: 3000 mm)



ST-A 40/9000A-4-ST
 surface-mounted track ONETrack Advance with data bus
 (length: 4000 mm)



ST-E 10/9000-1-R
 recessed track ONETrack with data bus
 (length: 1000 mm)



ST-E 20/9000-2-R
 recessed track ONETrack with data bus
 (length: 2000 mm)



ST-E 30/9000-3-R
 recessed track ONETrack with data bus
 (length: 3000 mm)



ST-E 40/9000-4-R
 recessed track ONETrack with data bus
 (length: 4000 mm)



ZB-AGS 002
 anti-glare shield



ZB-DAR 002
 decorative anti-glare ring



ZB-OR DONGLE
 Organic Response IR dongle kit



ZB-OR GATEWAY
 Organic Response IoT Gateway Cascade Series

Track-Mounted Spotlights · ORYO 200 Track-Mounted



ORYO-T 203.940.45/DALI-ST

Accessories



ZB-OR-T SENSOR
Organic Response sensor for track mounting



ZBW 89
honeycomb louvre