

ORYO-T 101.930.25/CAS

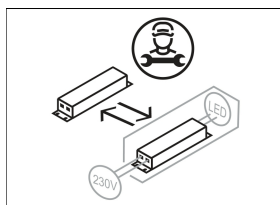

Colours	Article no.	EAN
silver	659246	4043544784469
black	659247	4043544784476
white	659248	4043544784483

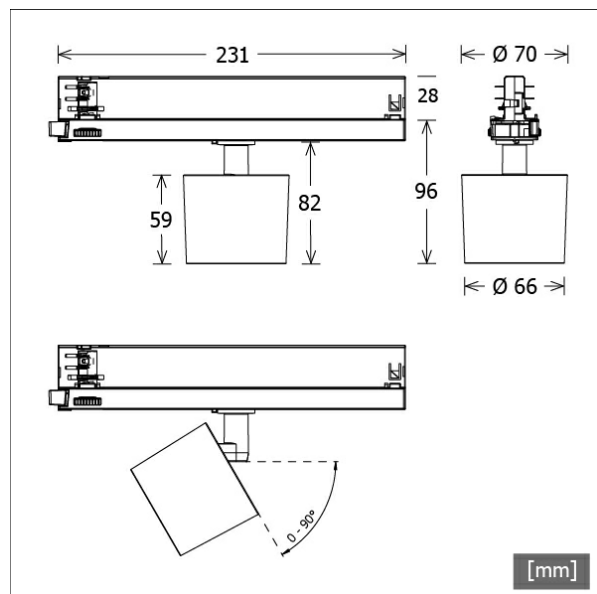

Description

- flexible filigree track-mounted spotlight with slightly conical light-head
- light-head rotates through 355° and pivots through 90° via integrated articulated arm
- outstanding ease of maintenance
- no UV and thermal emissions
- anti-glare shield and decorative anti-glare ring available as accessories
- light-head made from die-cast aluminium
- innovative thermal management with design-integrated passive cooling
- high performance specular aluminium reflector with precise symmetrical beam characteristic for high luminous efficiency and glare-free lighting
- black internal thermoplastic front ring
- clear acrylic safety glass
- ballast with Casambi technology for wireless light control via app or compatible switch
- 3-phase track adapter (ONETrack) with integrated ballast for wireless communication network

Notes

Not compatible with ONETrack Trimless tracks.

Standard options



Lighting data / Norms

Lamps	LED Spot / CRI 90 / 3000 K
EPREL light sources	851296
	L90 B50 50.000 h
	L80 B50 100.000 h
	L80 B20 50.000 h
Lifetime	20.0 W
System power	1730 lm
Luminaire luminous flux	86.50 lm/W
System efficiency	134.21 lm/W
Module efficiency	≤19
UGR class	Medium Flood
Beam range	30°
Beam angle	220 - 240 V / 50 - 60 Hz
Supply voltage	II
Protection class	IP20
Type of protection	

Dimensions / Weights

Length	260 mm
Width	66 mm
Height	96 mm
Diameter of light head	66 mm
Net weight	0.44 kg
Gross weight	0.54 kg

ORYO-T 101.930.25/CAS

Oryo 100 | Track-Mounted (1xLED 20W 930/3000K 1730lm)

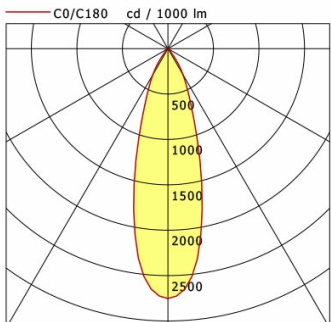

	C0	C90	C180	C270
0°	2753	2753	2753	2753
15°	1403	1403	1403	1403
30°	332	332	332	332
45°	17	17	17	17
60°	7	7	7	7
75°	2	2	2	2
90°	0	0	0	0
cd / 1000 lm				

Offset [m]	Cone width [m]	Illuminance [lx]
3.0	1.63	529.1
6.0	3.26	132.3
9.0	4.89	58.8
12.0	6.53	33.1
15.0	8.16	21.2

η	LED
Efficiency	87 lm/W
Direct/Indirect	↓ 100% / ↑ 0%
System Power	20 W
UGR	X=4H, Y=8H
Reflection factors	70/50/20
UGR C0/C180	19.2
UGR C90/C270	19.2
CIE Flux Codes	97 99 100 100 100
Ra/CRI	>90

LTS

Accessories



ST-A 10/9000A-1-ST
surface-mounted track ONETrack Advance with data bus
(length: 1000 mm)



ST-A 20/9000A-2-ST
surface-mounted track ONETrack Advance with data bus
(length: 2000 mm)



ST-A 30/9000A-3-ST
surface-mounted track ONETrack Advance with data bus
(length: 3000 mm)



ST-A 40/9000A-4-ST
surface-mounted track ONETrack Advance with data bus
(length: 4000 mm)



ST-E 10/9000-1-R
recessed track ONETrack with data bus
(length: 1000 mm)



ST-E 20/9000-2-R
recessed track ONETrack with data bus
(length: 2000 mm)



ST-E 30/9000-3-R
recessed track ONETrack with data bus
(length: 3000 mm)



ST-E 40/9000-4-R
recessed track ONETrack with data bus
(length: 4000 mm)



ZB-AGS 001
anti-glare shield



ZB-DAR 001
decorative anti-glare ring



ZBW 88
honeycomb louvre