

## ORYO-T 101.930.45/CAS



## Description

- flexible filigree track-mounted spotlight with slightly conical light-head
- light-head rotates through 355° and pivots through 90° via integrated articulated arm
- outstanding ease of maintenance
- no UV and thermal emissions
- anti-glare shield and decorative anti-glare ring available as accessories
- light-head made from die-cast aluminium
- innovative thermal management with design-integrated passive cooling
- high performance specular aluminium reflector with precise symmetrical beam characteristic for high luminous efficiency and glare-free lighting
- black internal thermoplastic front ring
- clear acrylic safety glass
- ballast with Casambi technology for wireless light control via app or compatible switch
- 3-phase track adapter (ONETrack) with integrated ballast for wireless communication network



Colours	Article no.	EAN
silver	659249	4043544784490
black	659250	4043544784506
white	659251	4043544784513

## Notes

Not compatible with ONETrack Trimless tracks.

## Standard options



## Lighting data / Norms

Lamps	LED Spot / CRI 90 / 3000 K
EPREL light sources	851296
	L90 B50 50.000 h
	L80 B50 100.000 h
	L80 B20 50.000 h
Lifetime	20.0 W
System power	1840 lm
Luminaire luminous flux	92.00 lm/W
System efficiency	134.21 lm/W
Module efficiency	≤22
UGR class	Wide Flood
Beam range	46°
Beam angle	220 - 240 V / 50 - 60 Hz
Supply voltage	II
Protection class	IP20
Type of protection	

## Dimensions / Weights

Length	260 mm
Width	66 mm
Height	96 mm
Diameter of light head	66 mm
Net weight	0.44 kg
Gross weight	0.54 kg

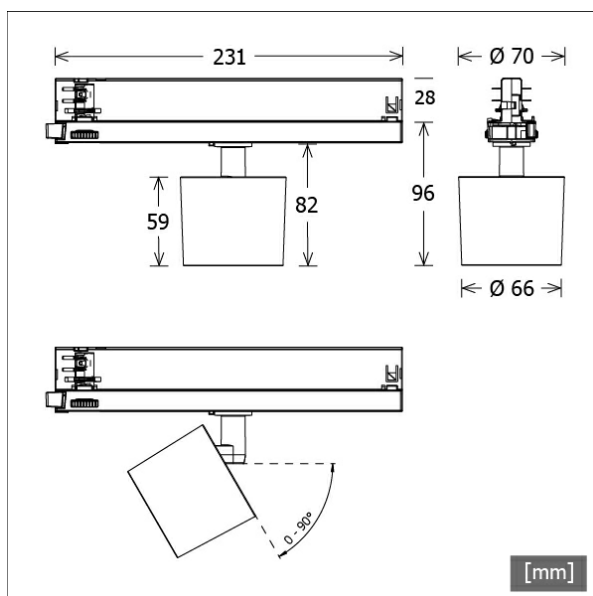

# ORYO-T 101.930.45/CAS

Oryo 100 | Track-Mounted (1xLED 20W 930/3000K 1840lm)

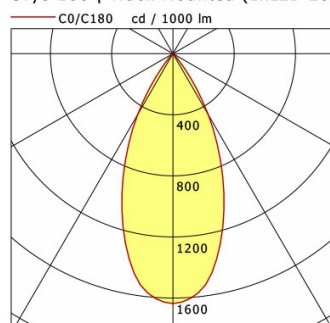

	C0	C90	C180	C270
0°	1636	1636	1636	1636
15°	1232	1232	1232	1232
30°	461	461	461	461
45°	24	24	24	24
60°	8	8	8	8
75°	2	2	2	2
90°	0	0	0	0

cd / 1000 lm

Offset [m]	Cone width [m]	Illuminance [lx]
3.0	2.54	334.5
6.0	5.08	83.6
9.0	7.62	37.2
12.0	10.16	20.9
15.0	12.70	13.4

C0-C180 Plane

<b>η</b>	LED
Efficiency	92 lm/W
Direct/Indirect	↓ 100% / ↑ 0%
System Power	20 W
<b>UGR</b>	X=4H, Y=8H
Reflection factors	70/50/20
UGR C0/C180	21.5
UGR C90/C270	21.5
CIE Flux Codes	96 99 100 100 100
Ra/CRI	>90

LTS

## Accessories



**ST-A 10/9000A-1-ST**  
 surface-mounted track ONETrack Advance with data bus  
 (length: 1000 mm)



**ST-A 20/9000A-2-ST**  
 surface-mounted track ONETrack Advance with data bus  
 (length: 2000 mm)



**ST-A 30/9000A-3-ST**  
 surface-mounted track ONETrack Advance with data bus  
 (length: 3000 mm)



**ST-A 40/9000A-4-ST**  
 surface-mounted track ONETrack Advance with data bus  
 (length: 4000 mm)



**ST-E 10/9000-1-R**  
 recessed track ONETrack with data bus  
 (length: 1000 mm)



**ST-E 20/9000-2-R**  
 recessed track ONETrack with data bus  
 (length: 2000 mm)



**ST-E 30/9000-3-R**  
 recessed track ONETrack with data bus  
 (length: 3000 mm)



**ST-E 40/9000-4-R**  
 recessed track ONETrack with data bus  
 (length: 4000 mm)



**ZB-AGS 001**  
 anti-glare shield



**ZB-DAR 001**  
 decorative anti-glare ring



**ZBW 88**  
 honeycomb louvre