

ORYO-T 101.940.45/CAS

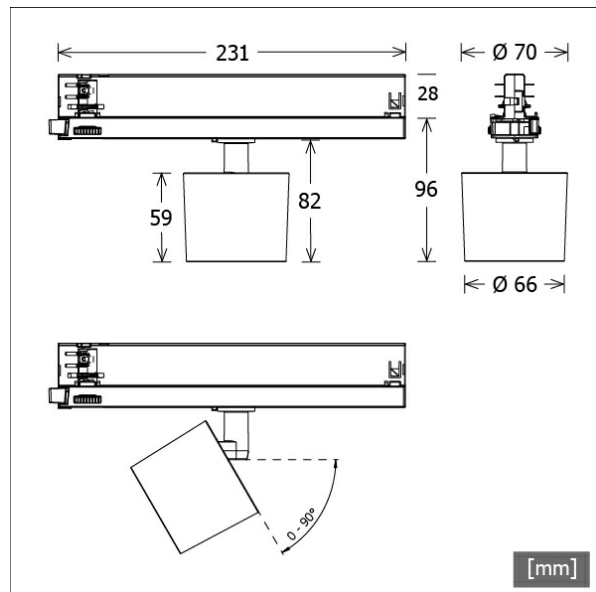

Colours	Article no.	EAN
silver	659258	4043544784582
black	659259	4043544784599
white	659260	4043544784605



Description

- flexible filigree track-mounted spotlight with slightly conical light-head
- light-head rotates through 355° and pivots through 90° via integrated articulated arm
- outstanding ease of maintenance
- no UV and thermal emissions
- anti-glare shield and decorative anti-glare ring available as accessories
- light-head made from die-cast aluminium
- innovative thermal management with design-integrated passive cooling
- high performance specular aluminium reflector with precise symmetrical beam characteristic for high luminous efficiency and glare-free lighting
- black internal thermoplastic front ring
- clear acrylic safety glass
- ballast with Casambi technology for wireless light control via app or compatible switch
- 3-phase track adapter (ONETrack) with integrated ballast for wireless communication network

Notes

Not compatible with ONETrack Trimless tracks.

Standard options



Lighting data / Norms

Lamps	LED Spot / CRI 90 / 4000 K
EPREL light sources	854571
	L90 B50 50.000 h
	L80 B50 100.000 h
	L80 B20 50.000 h
Lifetime	20.0 W
System power	1940 lm
Luminaire luminous flux	97.00 lm/W
System efficiency	140.95 lm/W
Module efficiency	≤22
UGR class	Wide Flood
Beam range	46°
Beam angle	220 - 240 V / 50 - 60 Hz
Supply voltage	II
Protection class	IP20
Type of protection	

Dimensions / Weights

Length	260 mm
Width	66 mm
Height	96 mm
Diameter of light head	66 mm
Net weight	0.44 kg
Gross weight	0.54 kg

ORYO-T 101.940.45/CAS

Oryo 100 | Track-Mounted (1xLED 20W 940/4000K 1940lm)

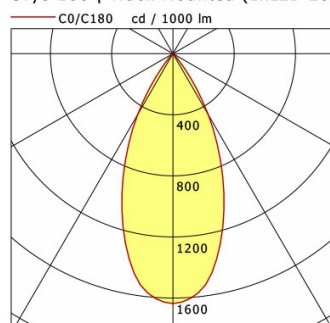

	C0	C90	C180	C270
0°	1636	1636	1636	1636
15°	1232	1232	1232	1232
30°	461	461	461	461
45°	24	24	24	24
60°	8	8	8	8
75°	2	2	2	2
90°	0	0	0	0
cd / 1000 lm				

Offset [m]	Cone width [m]	Illuminance [lx]
3.0	2.54	352.6
6.0	5.08	88.2
9.0	7.62	39.2
12.0	10.16	22.0
15.0	12.70	14.1

Diagram illustrating the cone width and illuminance of the ORYO-T 101.940.45/CAS spotlight. The cone is shown as a yellow triangle, with the label 'C0-C180 Plane' at the top.

η	LED
Efficiency	97 lm/W
Direct/Indirect	↓ 100% / ↑ 0%
System Power	20 W
UGR	X=4H, Y=8H
Reflection factors	70/50/20
UGR C0/C180	21.7
UGR C90/C270	21.7
CIE Flux Codes	96 99 100 100 100
Ra/CRI	>90

LTS

Accessories



ST-A 10/9000A-1-ST
 surface-mounted track ONETrack Advance with data bus
 (length: 1000 mm)



ST-A 20/9000A-2-ST
 surface-mounted track ONETrack Advance with data bus
 (length: 2000 mm)



ST-A 30/9000A-3-ST
 surface-mounted track ONETrack Advance with data bus
 (length: 3000 mm)



ST-A 40/9000A-4-ST
 surface-mounted track ONETrack Advance with data bus
 (length: 4000 mm)



ST-E 10/9000-1-R
 recessed track ONETrack with data bus
 (length: 1000 mm)



ST-E 20/9000-2-R
 recessed track ONETrack with data bus
 (length: 2000 mm)



ST-E 30/9000-3-R
 recessed track ONETrack with data bus
 (length: 3000 mm)



ST-E 40/9000-4-R
 recessed track ONETrack with data bus
 (length: 4000 mm)



ZB-AGS 001
 anti-glare shield



ZB-DAR 001
 decorative anti-glare ring



ZBW 88
 honeycomb louvre