

ORYO-T 203.940.25/CAS



Description

- flexible track-mounted spotlight with slightly conical light-head
- light-head rotates through 355° and pivots through 90° via integrated articulated arm
- outstanding ease of maintenance
- no UV and thermal emissions
- anti-glare shield and decorative anti-glare ring available as accessories
- light-head made from die-cast aluminium
- innovative thermal management with design-integrated passive cooling
- high performance specular aluminium reflector with precise symmetrical beam characteristic for high luminous efficiency and glare-free lighting
- black internal thermoplastic front ring
- clear safety glass
- ballast with Casambi technology for wireless light control via app or compatible switch
- 3-phase track adapter (ONETrack) with integrated ballast for wireless communication network

Notes

Not compatible with ONETrack Trimless tracks.

Standard options



Lighting data / Norms

| | |
|-------------------------|----------------------------|
| Lamps | LED Spot / CRI 90 / 4000 K |
| EPREL light sources | 847894 |
| | L90 B50 50.000 h |
| | L80 B50 100.000 h |
| | L80 B20 50.000 h |
| Lifetime | 30.0 W |
| System power | 3290 lm |
| Luminaire luminous flux | 109.66 lm/W |
| System efficiency | 149.15 lm/W |
| Module efficiency | ≤19 |
| UGR class | Medium Flood |
| Beam range | 29° |
| Beam angle | 220 - 240 V / 50 - 60 Hz |
| Supply voltage | II |
| Protection class | IP20 |
| Type of protection | |

Dimensions / Weights

| | |
|------------------------|---------|
| Length | 231 mm |
| Width | 85 mm |
| Height | 108 mm |
| Diameter of light head | 85 mm |
| Net weight | 0.66 kg |
| Gross weight | 0.76 kg |

| Colours | Article no. | EAN |
|---------|-------------|---------------|
| silver | 659201 | 4043544784018 |
| black | 659202 | 4043544784025 |
| white | 659203 | 4043544784032 |

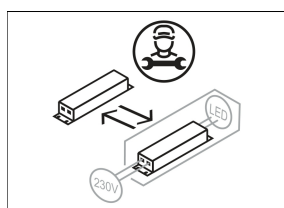
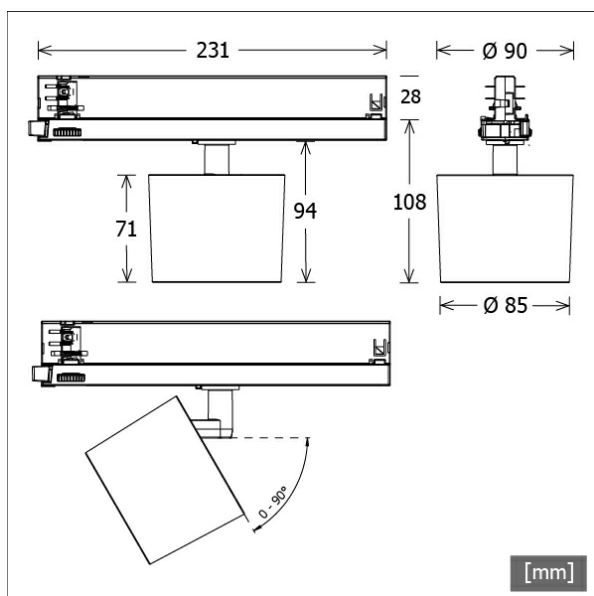

ORYO-T 203.940.25/CAS

Oryo 200 | Track-Mounted (1xLED 30W 940/4000K 3290lm)

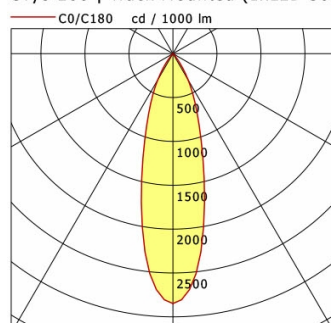

| | C0 | C90 | C180 | C270 |
|--------------|------|------|------|------|
| 0° | 2848 | 2848 | 2848 | 2848 |
| 15° | 1347 | 1347 | 1347 | 1347 |
| 30° | 346 | 346 | 346 | 346 |
| 45° | 12 | 12 | 12 | 12 |
| 60° | 7 | 7 | 7 | 7 |
| 75° | 1 | 1 | 1 | 1 |
| 90° | 0 | 0 | 0 | 0 |
| cd / 1000 lm | | | | |

| Offset [m] | Cone width [m] | Illuminance [lx] |
|------------|----------------|------------------|
| 3.0 | 1.54 | 1041.2 |
| 6.0 | 3.08 | 260.3 |
| 9.0 | 4.62 | 115.7 |
| 12.0 | 6.16 | 65.1 |
| 15.0 | 7.70 | 41.6 |

| | |
|--------------------|--------------------|
| η | LED |
| Efficiency | 110 lm/W |
| Direct/Indirect | ↓ 100% / ↑ 0% |
| System Power | 30 W |
| UGR | X=4H, Y=8H |
| Reflection factors | 70/50/20 |
| UGR C0/C180 | 19.1 |
| UGR C90/C270 | 19.1 |
| CIE Flux Codes | 98 100 100 100 100 |
| Ra/CRI | >90 |

LTS

Accessories



ST-A 10/9000A-1-ST
 surface-mounted track ONETrack Advance with data bus
 (length: 1000 mm)



ST-A 20/9000A-2-ST
 surface-mounted track ONETrack Advance with data bus
 (length: 2000 mm)



ST-A 30/9000A-3-ST
 surface-mounted track ONETrack Advance with data bus
 (length: 3000 mm)



ST-A 40/9000A-4-ST
 surface-mounted track ONETrack Advance with data bus
 (length: 4000 mm)



ST-E 10/9000-1-R
 recessed track ONETrack with data bus
 (length: 1000 mm)



ST-E 20/9000-2-R
 recessed track ONETrack with data bus
 (length: 2000 mm)



ST-E 30/9000-3-R
 recessed track ONETrack with data bus
 (length: 3000 mm)



ST-E 40/9000-4-R
 recessed track ONETrack with data bus
 (length: 4000 mm)



ZB-AGS 002
 anti-glare shield



ZB-DAR 002
 decorative anti-glare ring



ZBW 89
 honeycomb louvre