

ORYO-T 202.B.25



Description

- flexible track-mounted spotlight with slightly conical light-head for special lighting of bakery products
- light-head rotates through 355° and pivots through 90° via integrated articulated arm
- outstanding ease of maintenance
- no UV and thermal emissions
- anti-glare shield and decorative anti-glare ring available as accessories
- light-head made from die-cast aluminium
- innovative thermal management with design-integrated passive cooling
- high performance specular aluminium reflector with precise symmetrical beam characteristic for high luminous efficiency and glare-free lighting
- black internal thermoplastic front ring
- clear safety glass
- 3-phase track adapter with integrated ballast

Notes

Not compatible with ONETrack Trimless tracks.

Standard options



Special options



Lighting data / Norms

Lamps	LED Spot Bakery / CRI 82
EPREL light sources	832579
Lifetime	L90 B50 50.000 h L80 B50 100.000 h L80 B20 50.000 h
System power	25.7 W
Luminaire luminous flux	2670 lm
System efficiency	103.89 lm/W
Module efficiency	109.90 lm/W
UGR class	≤19
Beam range	Medium Flood
Beam angle	25°
Supply voltage	220 - 240 V / 50 - 60 Hz
Protection class	II
Type of protection	IP20

Dimensions / Weights

Length	231 mm
Width	85 mm
Height	108 mm
Diameter of light head	85 mm
Net weight	0.68 kg
Gross weight	0.78 kg

Colours	Article no.	EAN
silver	659447	4043544786432
black	659448	4043544786449
white	659449	4043544786456

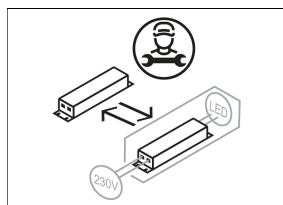
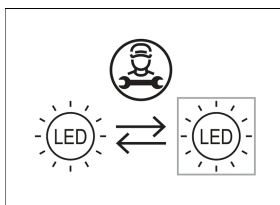
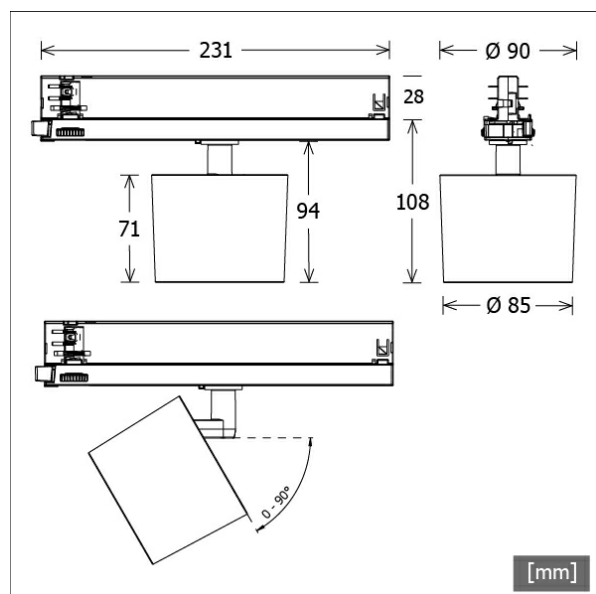

ORYO-T 202.B.25

ORYO-T 202.B.25

Oryo 200 | Track-Mounted (1xLED 26W BAKERY 2670lm)

C0/C180 cd / 1000 lm

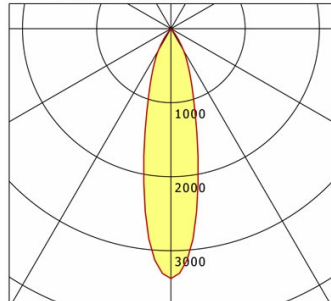

	C0	C90	C180	C270
0°	3376	3376	3376	3376
15°	1307	1307	1307	1307
30°	341	341	341	341
45°	11	11	11	11
60°	7	7	7	7
75°	1	1	1	1
90°	0	0	0	0

cd / 1000 lm

Offset [m] Cone width [m] Illuminance [lx]

Offset [m]	Cone width [m]	Illuminance [lx]
3.0	1.32	1001.6
6.0	2.64	250.4
9.0	3.97	111.3
12.0	5.29	62.6
15.0	6.61	40.1

η	LED
Efficiency	103 lm/W
Direct/Indirect	↓ 100% / ↑ 0%
System Power	26 W
UGR	X=4H, Y=8H
Reflection factors	70/50/20
UGR C0/C180	18.1
UGR C90/C270	18.1
CIE Flux Codes	98 100 100 100 100
Ra/CRI	---

LTS

Accessories



ST-A 10/9000A-1-ST
 surface-mounted track ONETrack Advance with data bus
 (length: 1000 mm)



ST-A 20/9000A-2-ST
 surface-mounted track ONETrack Advance with data bus
 (length: 2000 mm)



ST-A 30/9000A-3-ST
 surface-mounted track ONETrack Advance with data bus
 (length: 3000 mm)



ST-A 40/9000A-4-ST
 surface-mounted track ONETrack Advance with data bus
 (length: 4000 mm)



ST-E 10/9000-1-R
 recessed track ONETrack with data bus
 (length: 1000 mm)



ST-E 20/9000-2-R
 recessed track ONETrack with data bus
 (length: 2000 mm)



ST-E 30/9000-3-R
 recessed track ONETrack with data bus
 (length: 3000 mm)



ST-E 40/9000-4-R
 recessed track ONETrack with data bus
 (length: 4000 mm)



ZB-AGS 002
 anti-glare shield



ZB-DAR 002
 decorative anti-glare ring



ZBW 89
 honeycomb louvre