

ORYO-T 201.927.L06/DALI-ST

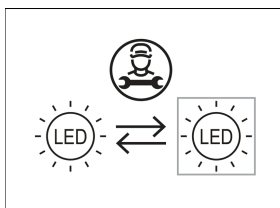

| Colours | Article no. | EAN |
|---------|-------------|---------------|
| silver | 659070 | 4043544782724 |
| black | 659071 | 4043544782731 |
| white | 659072 | 4043544782748 |

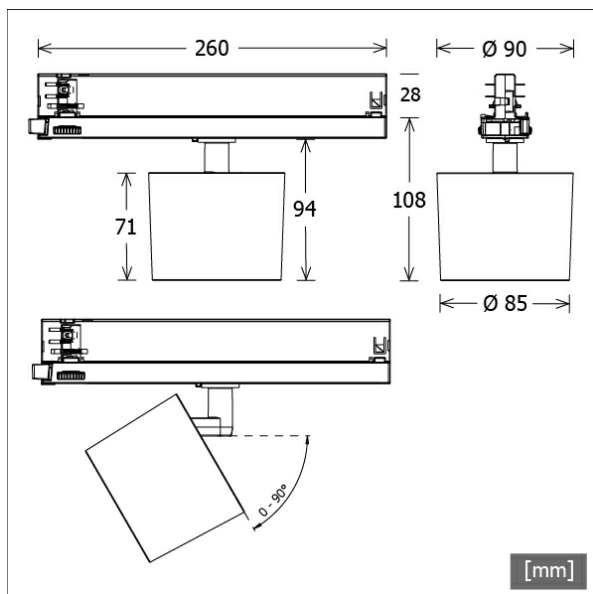

Description

- flexible track-mounted spotlight with slightly conical light-head
- light-head rotates through 355° and pivots through 90° via integrated articulated arm
- outstanding ease of maintenance
- no UV and thermal emissions
- anti-glare shield and decorative anti-glare ring available as accessories
- light-head made from die-cast aluminium
- innovative thermal management with design-integrated passive cooling
- black internal thermoplastic front ring
- high-quality Fresnel lens made of PMMA (Made in Germany) suitable for accentuation
- 3-phase track adapter (ONETrack) with integrated DALI ballast

Notes

Compatible with power tracks ONETrack and Global Trac PULSE. Not compatible with ONETrack Trimless tracks.

Standard options



Lighting data / Norms

| | |
|-------------------------|----------------------------|
| Lamps | LED Spot / CRI 90 / 2700 K |
| EPREL light sources | 881632 |
| | L90 B50 50.000 h |
| Lifetime | L80 B50 100.000 h |
| | L80 B20 50.000 h |
| System power | 20.2 W |
| Luminaire luminous flux | 510 lm |
| System efficiency | 25.24 lm/W |
| Module efficiency | 126.00 lm/W |
| UGR class | ≤22 |
| Beam range | Narrow Spot |
| Beam angle | 6° |
| Supply voltage | 220 - 240 V / 50 - 60 Hz |
| Protection class | II |
| Type of protection | IP20 |

Dimensions / Weights

| | |
|------------------------|---------|
| Length | 260 mm |
| Width | 85 mm |
| Height | 108 mm |
| Diameter of light head | 85 mm |
| Net weight | 0.68 kg |
| Gross weight | 0.78 kg |

ORYO-T 201.927.L06/DALI-ST

ORYO-T 201.927.L06/DALI-ST

Oryo 200 | Track-Mounted (1xLED 20W 927/2700K 510lm)

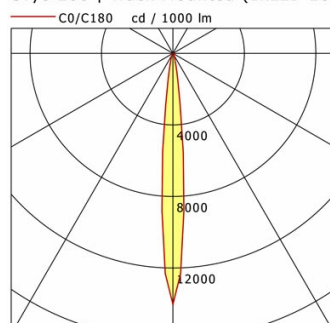

| | C0 | C90 | C180 | C270 |
|--------------|-------|-------|-------|-------|
| 0° | 14031 | 14031 | 14031 | 14031 |
| 15° | 557 | 557 | 557 | 557 |
| 30° | 111 | 111 | 111 | 111 |
| 45° | 87 | 87 | 87 | 87 |
| 60° | 59 | 59 | 59 | 59 |
| 75° | 19 | 19 | 19 | 19 |
| 90° | 0 | 0 | 0 | 0 |
| cd / 1000 lm | | | | |

| Offset [m] | Cone width [m] | Illuminance [lx] |
|------------|----------------|------------------|
| 3.0 | 0.53 | 795.1 |
| 6.0 | 1.06 | 198.8 |
| 9.0 | 1.59 | 88.3 |
| 12.0 | 2.12 | 49.7 |
| 15.0 | 2.65 | 31.8 |

| | |
|--------------------|------------------|
| η | LED |
| Efficiency | 26 lm/W |
| Direct/Indirect | ↓ 100% / ↑ 0% |
| System Power | 20 W |
| UGR | X=4H, Y=8H |
| Reflection factors | 70/50/20 |
| UGR C0/C180 | 22.0 |
| UGR C90/C270 | 22.0 |
| CIE Flux Codes | 81 93 99 100 100 |
| Ra/CRI | >90 |

LTS

Accessories



ST-A 10/9000A-1-ST
 surface-mounted track ONETrack Advance with data bus
 (length: 1000 mm)



ST-A 20/9000A-2-ST
 surface-mounted track ONETrack Advance with data bus
 (length: 2000 mm)



ST-A 30/9000A-3-ST
 surface-mounted track ONETrack Advance with data bus
 (length: 3000 mm)



ST-A 40/9000A-4-ST
 surface-mounted track ONETrack Advance with data bus
 (length: 4000 mm)



ST-E 10/9000-1-R
 recessed track ONETrack with data bus
 (length: 1000 mm)



ST-E 20/9000-2-R
 recessed track ONETrack with data bus
 (length: 2000 mm)



ST-E 30/9000-3-R
 recessed track ONETrack with data bus
 (length: 3000 mm)



ST-E 40/9000-4-R
 recessed track ONETrack with data bus
 (length: 4000 mm)



ZB-AGS 002
 anti-glare shield



ZB-DAR 002
 decorative anti-glare ring



ZB-OR DONGLE
 Organic Response IR dongle kit



ZB-OR GATEWAY
 Organic Response IoT Gateway Cascade Series

Track-Mounted Spotlights · ORYO 200 Track-Mounted



ORYO-T 201.927.L06/DALI-ST

Accessories



ZB-OR-T SENSOR
Organic Response sensor for track mounting