

ORYO-T 201.930.L06/DALI-ST

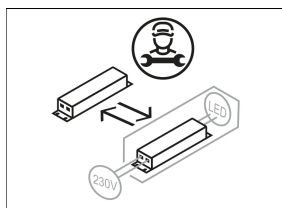

Colours	Article no.	EAN
silver	659079	4043544782816
black	659080	4043544782823
white	659081	4043544782830

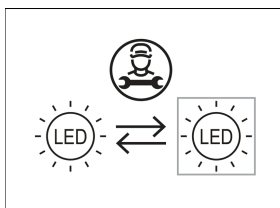
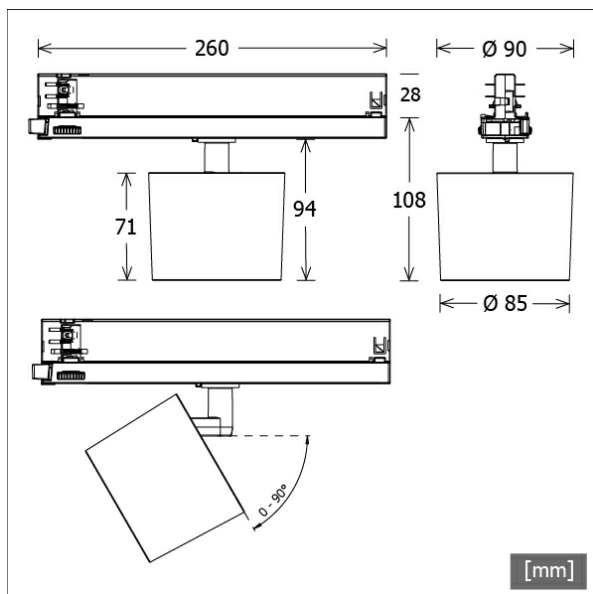

Description

- flexible track-mounted spotlight with slightly conical light-head
- light-head rotates through 355° and pivots through 90° via integrated articulated arm
- outstanding ease of maintenance
- no UV and thermal emissions
- anti-glare shield and decorative anti-glare ring available as accessories
- light-head made from die-cast aluminium
- innovative thermal management with design-integrated passive cooling
- black internal thermoplastic front ring
- high-quality Fresnel lens made of PMMA (Made in Germany) suitable for accentuation
- 3-phase track adapter (ONETrack) with integrated DALI ballast

Notes

Compatible with power tracks ONETrack and Global Trac PULSE. Not compatible with ONETrack Trimless tracks.

Standard options



Lighting data / Norms

Lamps	LED Spot / CRI90 / 3000 K
EPREL light sources	881633
	L90 B50 50.000 h
Lifetime	L80 B50 100.000 h
	L80 B20 50.000 h
System power	20.2 W
Luminaire luminous flux	530 lm
System efficiency	26.23 lm/W
Module efficiency	133.00 lm/W
UGR class	≤22
Beam range	Narrow Spot
Beam angle	6°
Supply voltage	220 - 240 V / 50 - 60 Hz
Protection class	II
Type of protection	IP20

Dimensions / Weights

Length	260 mm
Width	85 mm
Height	108 mm
Diameter of light head	85 mm
Net weight	0.68 kg
Gross weight	0.78 kg

ORYO-T 201.930.L06/DALI-ST

ORYO-T 201.930.L06/DALI-ST

Oryo 200 | Track-Mounted (1xLED 20W 930/3000K 530lm)

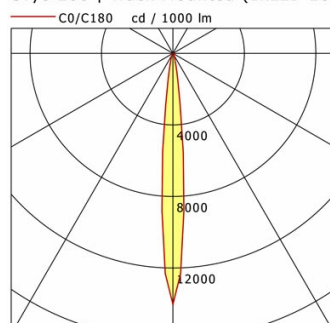

	C0	C90	C180	C270
0°	14031	14031	14031	14031
15°	557	557	557	557
30°	111	111	111	111
45°	87	87	87	87
60°	59	59	59	59
75°	19	19	19	19
90°	0	0	0	0
cd / 1000 lm				

Offset [m]	Cone width [m]	Illuminance [lx]
3.0	0.53	826.3
6.0	1.06	206.6
9.0	1.59	91.8
12.0	2.12	51.6
15.0	2.65	33.1

η	LED
Efficiency	27 lm/W
Direct/Indirect	↓ 100% / ↑ 0%
System Power	20 W
UGR	X=4H, Y=8H
Reflection factors	70/50/20
UGR C0/C180	22.1
UGR C90/C270	22.1
CIE Flux Codes	81 93 99 100 100
Ra/CRI	>90

LTS

Accessories



ST-A 10/9000A-1-ST
 surface-mounted track ONETrack Advance with data bus
 (length: 1000 mm)



ST-A 20/9000A-2-ST
 surface-mounted track ONETrack Advance with data bus
 (length: 2000 mm)



ST-A 30/9000A-3-ST
 surface-mounted track ONETrack Advance with data bus
 (length: 3000 mm)



ST-A 40/9000A-4-ST
 surface-mounted track ONETrack Advance with data bus
 (length: 4000 mm)



ST-E 10/9000-1-R
 recessed track ONETrack with data bus
 (length: 1000 mm)



ST-E 20/9000-2-R
 recessed track ONETrack with data bus
 (length: 2000 mm)



ST-E 30/9000-3-R
 recessed track ONETrack with data bus
 (length: 3000 mm)



ST-E 40/9000-4-R
 recessed track ONETrack with data bus
 (length: 4000 mm)



ZB-AGS 002
 anti-glare shield



ZB-DAR 002
 decorative anti-glare ring



ZB-OR DONGLE
 Organic Response IR dongle kit



ZB-OR GATEWAY
 Organic Response IoT Gateway Cascade Series

Track-Mounted Spotlights · ORYO 200 Track-Mounted



ORYO-T 201.930.L06/DALI-ST

Accessories



ZB-OR-T SENSOR
Organic Response sensor for track mounting