

JETT-R 102.930.SP/DALI

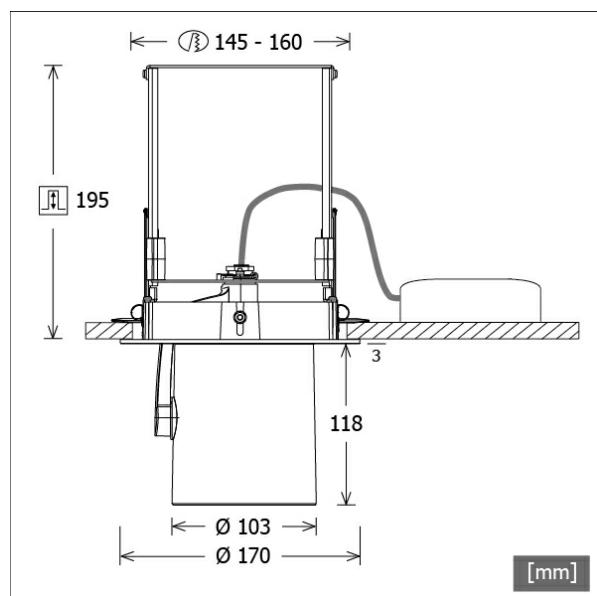

| Colours | Article no. | EAN |
|---------|-------------|---------------|
| silver | 668744 | 4043544804167 |
| black | 668745 | 4043544804174 |
| white | 668746 | 4043544804181 |



Description

- flexible recessed spotlight with cylindrical light-head
- light-head completely extracts, rotates through 355° and pivots through 90°
- outstanding ease of maintenance
- no UV and thermal emissions
- light-head made from die-cast aluminium
- innovative thermal management with design-integrated passive cooling
- specular aluminium reflector with precise symmetrical beam characteristic for high luminous efficiency and glare-free lighting
- recessed frame made from aluminium and sheet steel
- concealing plate for ceiling opening
- clear safety glass
- tool-free ceiling mounting via automatic quick clamping (automatic adjustment of the ceiling thickness)
- luminaire and ballast permanently connected via cable (length: 500 mm), ballast ready for mains connection
- ballast (LED converter DALI, dimmable) included (external placement)

Standard options

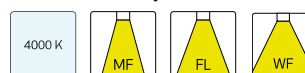

Special options



Lighting data / Norms

| | |
|--------------------------------|---|
| Lamps | LED Spot / CRI 90 / 3000 K |
| Lifetime | L90 B50 50.000 h L80 B50 100.000 h L80 B20 50.000 h |
| System power | 17.3 W |
| Luminaire luminous flux | 2250 lm |
| System efficiency | 130.05 lm/W |
| Module efficiency | 137.00 lm/W |
| UGR class | ≤19 |
| Beam range | Spot |
| Beam angle | 16° |
| Supply voltage | 220 - 240 V / 50 - 60 Hz |
| Protection class | II |
| Type of protection | IP20 |

Dimensions / Weights

| | |
|-------------------------------|---------------|
| Outer diameter | 170 mm |
| Height | 198 mm |
| Cut-out (Ø) | 145 mm |
| Ceiling thickness | 5.0 - 50.0 mm |
| Recessed depth | 195 mm |
| Diameter of light head | 103 mm |
| Net weight | 1.89 kg |
| Gross weight | 1.99 kg |

JETT-R 102.930.SP/DALI

JETT-R 102.930.SP/DALI

Jett Evo | Recessed (1xLED 17W 930/3000K 2250lm 16°)

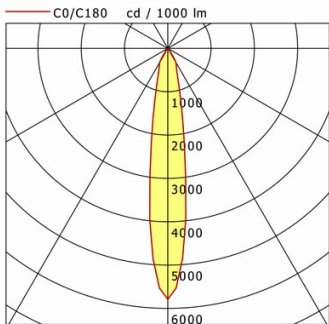

| | C0 | C90 | C180 | C270 |
|--------------|------|------|------|------|
| 0° | 5791 | 5791 | 5791 | 5791 |
| 15° | 1094 | 1094 | 1094 | 1094 |
| 30° | 371 | 371 | 371 | 371 |
| 45° | 10 | 10 | 10 | 10 |
| 60° | 7 | 7 | 7 | 7 |
| 75° | 1 | 1 | 1 | 1 |
| 90° | 0 | 0 | 0 | 0 |
| cd / 1000 lm | | | | |

| Offset [m] | Cone width [m] | Illuminance [lx] |
|---------------|----------------|------------------|
| C0-C180 Plane | | |
| 3.0 | 0.87 | 1447.7 |
| 6.0 | 1.73 | 361.9 |
| 9.0 | 2.60 | 160.9 |
| 12.0 | 3.47 | 90.5 |
| 15.0 | 4.33 | 57.9 |

| | |
|--------------------|--------------------|
| η | LED |
| Efficiency | 133 lm/W |
| Direct/Indirect | ↓ 100% / ↑ 0% |
| System Power | 17 W |
| UGR | X=4H, Y=8H |
| Reflection factors | 70/50/20 |
| UGR C0/C180 | 16.5 |
| UGR C90/C270 | 16.5 |
| CIE Flux Codes | 98 100 100 100 100 |
| Ra/CRI | >90 |

LTS

Accessories



FOCUS 100.1
superior optic with focusable biconvex lens for
accent lighting



ZB-OR DONGLE
Organic Response IR dongle kit



ZB-OR GATEWAY
Organic Response IoT Gateway Cascade Series



ZB-OR-R SENSOR
Organic Response sensor for recessed mounting



ZBK 96
anti-glare flaps



ZBW 83
honeycomb louvre



ZDAR 158.200-265
compensation ring for ceiling cut-outs from 200 to
265 mm



ZDVR 0157
ceiling reinforcement ring