

JETT-R 103.930.FL

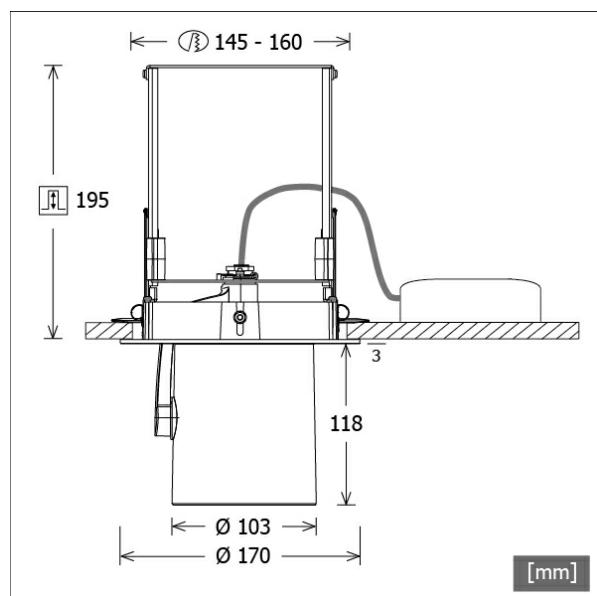

Colours	Article no.	EAN
silver	668802	4043544804730
black	668803	4043544804747
white	668804	4043544804754



Description

- flexible recessed spotlight with cylindrical light-head
- light-head completely extracts, rotates through 355° and pivots through 90°
- outstanding ease of maintenance
- no UV and thermal emissions
- light-head made from die-cast aluminium
- innovative thermal management with design-integrated passive cooling
- specular aluminium reflector with precise symmetrical beam characteristic for high luminous efficiency and glare-free lighting
- recessed frame made from aluminium and sheet steel
- concealing plate for ceiling opening
- clear safety glass
- tool-free ceiling mounting via automatic quick clamping (automatic adjustment of the ceiling thickness)
- luminaire and ballast permanently connected via cable (length: 500 mm), ballast ready for mains connection
- ballast (LED converter) included (external placement)

Standard options

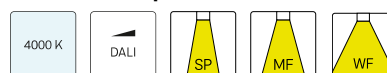

Special options



Lighting data / Norms

Lamps	LED Spot / CRI 90 / 3000 K
Lifetime	L90 B50 50.000 h L80 B50 100.000 h L80 B20 50.000 h
System power	24.1 W
Luminaire luminous flux	3120 lm
System efficiency	129.46 lm/W
Module efficiency	137.00 lm/W
UGR class	≤19
Beam range	Flood
Beam angle	36°
Supply voltage	220 - 240 V / 50 - 60 Hz
Protection class	II
Type of protection	IP20

Dimensions / Weights

Outer diameter	170 mm
Height	198 mm
Cut-out (Ø)	145 mm
Ceiling thickness	5.0 - 50.0 mm
Recessed depth	195 mm
Diameter of light head	103 mm
Net weight	1.88 kg
Gross weight	1.98 kg

JETT-R 103.930.FL

JETT-R 103.930.FL

Jett Evo | Recessed (1xLED 24W 930/3000K 3120lm 36°)

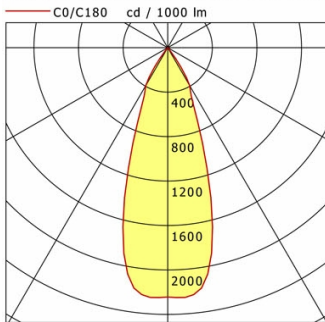

	C0	C90	C180	C270
0°	2244	2244	2244	2244
15°	1536	1536	1536	1536
30°	393	393	393	393
45°	11	11	11	11
60°	2	2	2	2
75°	1	1	1	1
90°	0	0	0	0
cd / 1000 lm				

Offset [m]	Cone width [m]	Illuminance [lx]
C0-C180 Plane		
3.0	1.97	777.8
6.0	3.94	194.5
9.0	5.90	86.4
12.0	7.87	48.6
15.0	9.84	31.1

η	LED
Efficiency	130 lm/W
Direct/Indirect	↓ 100% / ↑ 0%
System Power	24 W
UGR	X=4H, Y=8H
Reflection factors	70/50/20
UGR C0/C180	18.1
UGR C90/C270	18.1
CIE Flux Codes	99 100 100 100 100
Ra/CRI	>90

LTS

Accessories



FOCUS 100.1
superior optic with focusable biconvex lens for
accent lighting



ZBK 96
anti-glare flaps



ZBW 83
honeycomb louvre



ZDAR 158.200-265
compensation ring for ceiling cut-outs from 200 to
265 mm

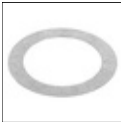

ZDVR 0157
ceiling reinforcement ring