

# JETT-R 103.940.WF/DALI

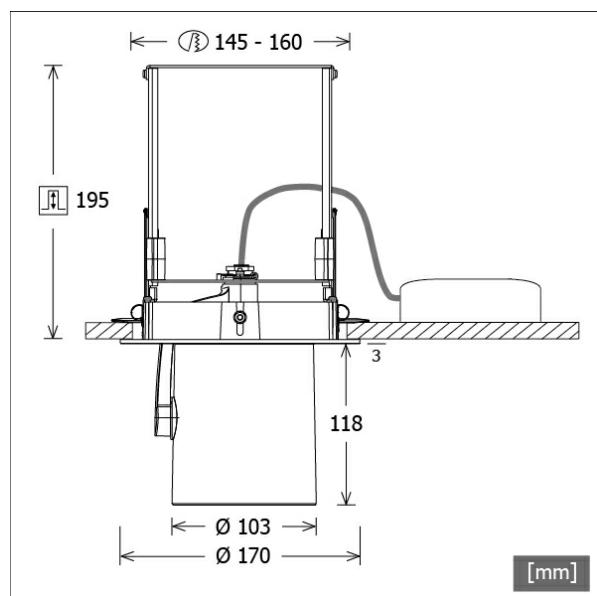

Colours	Article no.	EAN
silver	668835	4043544805065
black	668836	4043544805072
white	668837	4043544805089



## Description

- flexible recessed spotlight with cylindrical light-head
- light-head completely extracts, rotates through 355° and pivots through 90°
- outstanding ease of maintenance
- no UV and thermal emissions
- light-head made from die-cast aluminium
- innovative thermal management with design-integrated passive cooling
- specular aluminium reflector with precise symmetrical beam characteristic for high luminous efficiency and glare-free lighting
- recessed frame made from aluminium and sheet steel
- concealing plate for ceiling opening
- clear safety glass
- tool-free ceiling mounting via automatic quick clamping (automatic adjustment of the ceiling thickness)
- luminaire and ballast permanently connected via cable (length: 500 mm), ballast ready for mains connection
- ballast (LED converter DALI, dimmable) included (external placement)

## Standard options

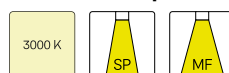

## Special options



## Lighting data / Norms

Lamps	LED Spot / CRI 90 / 4000 K
Lifetime	L90 B50 50.000 h L80 B50 100.000 h L80 B20 50.000 h
System power	24.1 W
Luminaire luminous flux	3140 lm
System efficiency	130.29 lm/W
Module efficiency	140.00 lm/W
UGR class	≤22
Beam range	Wide Flood
Beam angle	50°
Supply voltage	220 - 240 V / 50 - 60 Hz
Protection class	II
Type of protection	IP20

## Dimensions / Weights

Outer diameter	170 mm
Height	198 mm
Cut-out (Ø)	145 mm
Ceiling thickness	5.0 - 50.0 mm
Recessed depth	195 mm
Diameter of light head	103 mm
Net weight	1.89 kg
Gross weight	1.99 kg

# JETT-R 103.940.WF/DALI

## JETT-R 103.940.WF/DALI

Jett Evo | Recessed (1xLED 24W 940/4000K 3140lm 50°)

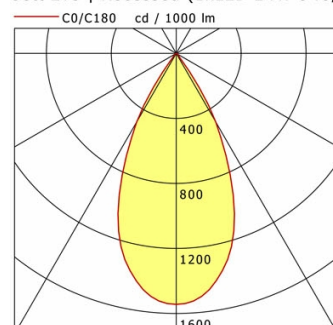

	C0	C90	C180	C270
0°	1544	1544	1544	1544
15°	1274	1274	1274	1274
30°	487	487	487	487
45°	18	18	18	18
60°	8	8	8	8
75°	2	2	2	2
90°	0	0	0	0
cd / 1000 lm				

Offset [m]	Cone width [m]	Illuminance [lx]
3.0	2.77	538.6
6.0	5.54	134.7
9.0	8.31	59.8
12.0	11.08	33.7
15.0	13.85	21.5

<b>η</b>	LED
Efficiency	131 lm/W
Direct/Indirect	↓ 100% / ↑ 0%
System Power	24 W
<b>UGR</b>	X=4H, Y=8H
Reflection factors	70/50/20
UGR C0/C180	19.7
UGR C90/C270	19.7
CIE Flux Codes	97 99 100 100 100
Ra/CRI	> 90

LTS

## Accessories



**FOCUS 100.1**  
superior optic with focusable biconvex lens for  
accent lighting



**ZB-OR DONGLE**  
Organic Response IR dongle kit



**ZB-OR GATEWAY**  
Organic Response IoT Gateway Cascade Series



**ZB-OR-R SENSOR**  
Organic Response sensor for recessed mounting



**ZBK 96**  
anti-glare flaps



**ZBW 83**  
honeycomb louvre



**ZDAR 158.200-265**  
compensation ring for ceiling cut-outs from 200 to  
265 mm

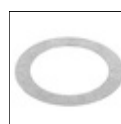

**ZDVR 0157**  
ceiling reinforcement ring