

JETT-R 104.930.WF

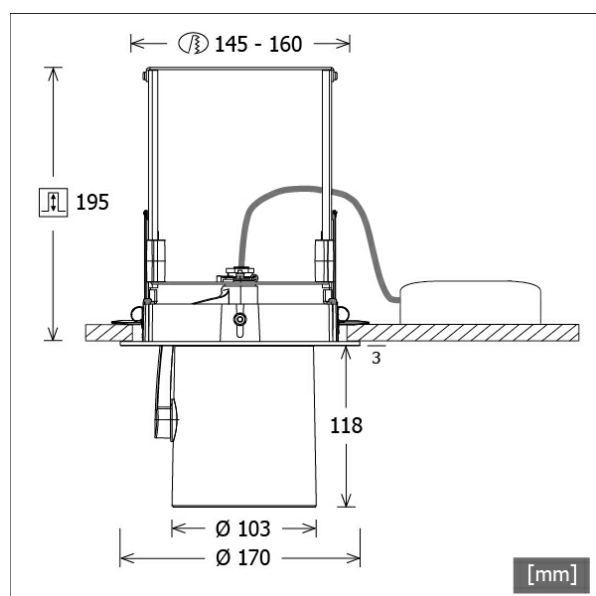

| Colours | Article no. | EAN |
|---------|-------------|---------------|
| silver | 668850 | 4043544805218 |
| black | 668851 | 4043544805225 |
| white | 668852 | 4043544805232 |



Description

- flexible recessed spotlight with cylindrical light-head
- light-head completely extracts, rotates through 355° and pivots through 90°
- outstanding ease of maintenance
- no UV and thermal emissions
- light-head made from die-cast aluminium
- innovative thermal management with design-integrated passive cooling
- specular aluminium reflector with precise symmetrical beam characteristic for high luminous efficiency and glare-free lighting
- recessed frame made from aluminium and sheet steel
- concealing plate for ceiling opening
- clear safety glass
- tool-free ceiling mounting via automatic quick clamping (automatic adjustment of the ceiling thickness)
- luminaire and ballast permanently connected via cable (length: 500 mm), ballast ready for mains connection
- ballast (LED converter) included (external placement)

Standard options



Special options



Lighting data / Norms

| | |
|--------------------------------|---|
| Lamps | LED Spot / CRI 90 / 3000 K |
| Lifetime | L90 B50 50.000 h L80 B50 100.000 h L80 B20 50.000 h |
| System power | 35.9 W |
| Luminaire luminous flux | 4250 lm |
| System efficiency | 118.38 lm/W |
| Module efficiency | 138.00 lm/W |
| UGR class | ≤22 |
| Beam range | Wide Flood |
| Beam angle | 50° |
| Supply voltage | 220 - 240 V / 50 - 60 Hz |
| Protection class | II |
| Type of protection | IP20 |

Dimensions / Weights

| | |
|-------------------------------|---------------|
| Outer diameter | 170 mm |
| Height | 198 mm |
| Cut-out (Ø) | 145 mm |
| Ceiling thickness | 5.0 - 50.0 mm |
| Recessed depth | 195 mm |
| Diameter of light head | 103 mm |
| Net weight | 1.88 kg |
| Gross weight | 1.98 kg |

JETT-R 104.930.WF

JETT-R 104.930.WF

Jett Evo | Recessed (1xLED 36W 930/3000K 4250lm 51°)

C0/C180 cd / 1000 lm

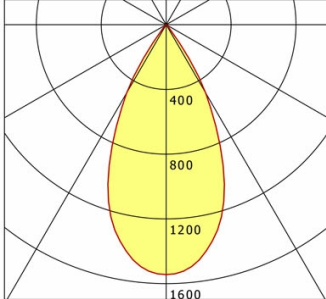

| | C0 | C90 | C180 | C270 |
|--------------|------|------|------|------|
| 0° | 1544 | 1544 | 1544 | 1544 |
| 15° | 1274 | 1274 | 1274 | 1274 |
| 30° | 487 | 487 | 487 | 487 |
| 45° | 18 | 18 | 18 | 18 |
| 60° | 8 | 8 | 8 | 8 |
| 75° | 2 | 2 | 2 | 2 |
| 90° | 0 | 0 | 0 | 0 |
| cd / 1000 lm | | | | |

Offset [m] Cone width [m] Illuminance [lx]

| Offset [m] | Cone width [m] | Illuminance [lx] |
|------------|----------------|------------------|
| 3.0 | 2.77 | 729.0 |
| 6.0 | 5.54 | 182.3 |
| 9.0 | 8.31 | 81.0 |
| 12.0 | 11.08 | 45.6 |
| 15.0 | 13.85 | 29.2 |

| | |
|--------------------|-------------------|
| η | LED |
| Efficiency | 118 lm/W |
| Direct/Indirect | ↓ 100% / ↑ 0% |
| System Power | 36 W |
| UGR | X=4H, Y=8H |
| Reflection factors | 70/50/20 |
| UGR C0/C180 | 20.7 |
| UGR C90/C270 | 20.7 |
| CIE Flux Codes | 97 99 100 100 100 |
| Ra/CRI | >90 |

LTS

Accessories



FOCUS 100.1
superior optic with focusable biconvex lens for
accent lighting



ZBK 96
anti-glare flaps



ZBW 83
honeycomb louvre



ZDAR 158.200-265
compensation ring for ceiling cut-outs from 200 to
265 mm



ZDVR 0157
ceiling reinforcement ring