

# JETT-R 104.940.MF/DALI

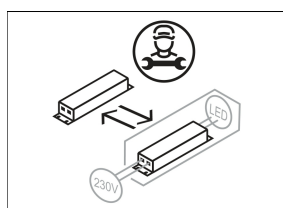

Colours	Article no.	EAN
silver	668859	4043544805300
black	668860	4043544805317
white	668861	4043544805324

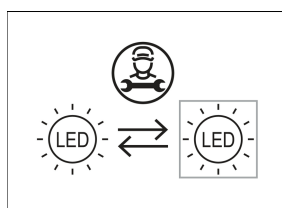
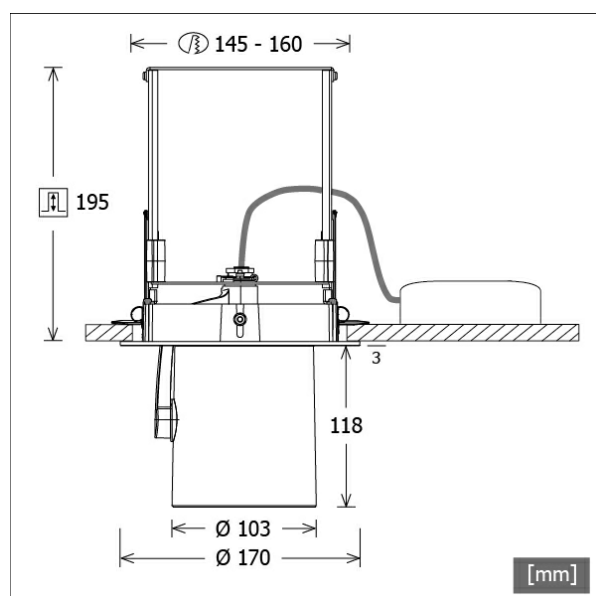

## Description

- flexible recessed spotlight with cylindrical light-head
- light-head completely extracts, rotates through 355° and pivots through 90°
- outstanding ease of maintenance
- no UV and thermal emissions
- light-head made from die-cast aluminium
- innovative thermal management with design-integrated passive cooling
- specular aluminium reflector with precise symmetrical beam characteristic for high luminous efficiency and glare-free lighting
- recessed frame made from aluminium and sheet steel
- concealing plate for ceiling opening
- clear safety glass
- tool-free ceiling mounting via automatic quick clamping (automatic adjustment of the ceiling thickness)
- luminaire and ballast permanently connected via cable (length: 500 mm), ballast ready for mains connection
- ballast (LED converter DALI, dimmable) included (external placement)

## Standard options

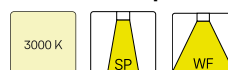

## Special options



## Lighting data / Norms

<b>Lamps</b>	LED Spot / CRI 90 / 4000 K
<b>Lifetime</b>	L90 B50 50.000 h L80 B50 100.000 h L80 B20 50.000 h
<b>System power</b>	35.9 W
<b>Luminaire luminous flux</b>	4500 lm
<b>System efficiency</b>	125.34 lm/W
<b>Module efficiency</b>	141.00 lm/W
<b>UGR class</b>	≤19
<b>Beam range</b>	Medium Flood
<b>Beam angle</b>	26°
<b>Supply voltage</b>	220 - 240 V / 50 - 60 Hz
<b>Protection class</b>	II
<b>Type of protection</b>	IP20

## Dimensions / Weights

<b>Outer diameter</b>	170 mm
<b>Height</b>	198 mm
<b>Cut-out (Ø)</b>	145 mm
<b>Ceiling thickness</b>	5.0 - 50.0 mm
<b>Recessed depth</b>	195 mm
<b>Diameter of light head</b>	103 mm
<b>Net weight</b>	1.89 kg
<b>Gross weight</b>	1.99 kg

# JETT-R 104.940.MF/DALI

## JETT-R 104.940.MF/DALI

Jett Evo | Recessed (1xLED 36W 940/4000K 4500lm 27°)

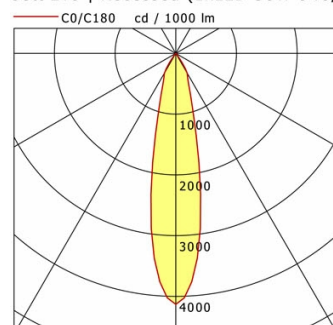

	C0	C90	C180	C270
0°	4131	4131	4131	4131
15°	1213	1213	1213	1213
30°	373	373	373	373
45°	13	13	13	13
60°	5	5	5	5
75°	1	1	1	1
90°	0	0	0	0
cd / 1000 lm				

Offset [m]	Cone width [m]	Illuminance [lx]
3.0	1.18	2065.5
6.0	2.36	516.4
9.0	3.54	229.5
12.0	4.72	129.1
15.0	5.91	82.6

<b>η</b>	LED
Efficiency	125 lm/W
Direct/Indirect	↓ 100% / ↑ 0%
System Power	36 W
<b>UGR</b>	X=4H, Y=8H
Reflection factors	70/50/20
UGR C0/C180	19.2
UGR C90/C270	19.2
CIE Flux Codes	98 100 100 100 100
Ra/CRI	>90

LTS

## Accessories



**FOCUS 100.1**  
superior optic with focusable biconvex lens for  
accent lighting



**ZB-OR DONGLE**  
Organic Response IR dongle kit



**ZB-OR GATEWAY**  
Organic Response IoT Gateway Cascade Series



**ZB-OR-R SENSOR**  
Organic Response sensor for recessed mounting



**ZBK 96**  
anti-glare flaps



**ZBW 83**  
honeycomb louvre



**ZDAR 158.200-265**  
compensation ring for ceiling cut-outs from 200 to  
265 mm

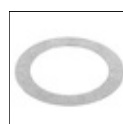

**ZDVR 0157**  
ceiling reinforcement ring