

# JETT-R 106.930.MF

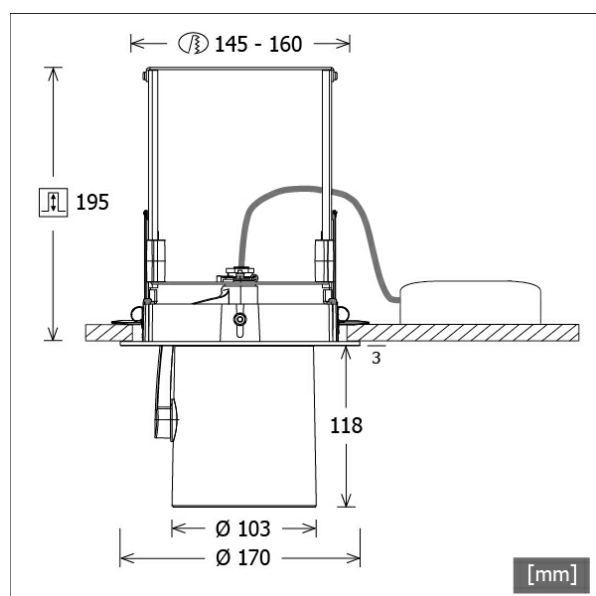

Colours	Article no.	EAN
silver	669548	4043544812193
black	669549	4043544812209
white	669550	4043544812216



## Description

- flexible recessed spotlight with cylindrical light-head
- light-head completely extracts, rotates through 355° and pivots through 90°
- outstanding ease of maintenance
- no UV and thermal emissions
- light-head made from die-cast aluminium
- innovative thermal management with design-integrated passive cooling
- specular aluminium reflector with precise symmetrical beam characteristic for high luminous efficiency and glare-free lighting
- recessed frame made from aluminium and sheet steel
- concealing plate for ceiling opening
- clear safety glass
- tool-free ceiling mounting via automatic quick clamping (automatic adjustment of the ceiling thickness)
- luminaire and ballast permanently connected via cable (length: 500 mm), ballast ready for mains connection
- ballast (LED converter) included (external placement)

## Notes

Luminaire must only be used in open ceiling systems.

## Standard options



## Special options



## Lighting data / Norms

Lamps	LED Spot / CRI 90 / 3000 K
Lifetime	L90 B50 50.000 h L80 B50 100.000 h L80 B20 50.000 h
System power	52.1 W
Luminaire luminous flux	6360 lm
System efficiency	122.07 lm/W
Module efficiency	138.00 lm/W
UGR class	≤25
Beam range	Medium Flood
Beam angle	26°
Supply voltage	220 - 240 V / 50 - 60 Hz
Protection class	II
Type of protection	IP20

## Dimensions / Weights

Outer diameter	170 mm
Height	198 mm
Cut-out (Ø)	145 mm
Ceiling thickness	5.0 - 50.0 mm
Recessed depth	195 mm
Diameter of light head	103 mm
Net weight	1.88 kg

Recessed Spotlights · Jett Evo Recessed

JETT-R 106.930.MF

Gross weight



LTS  
LOVE TO SHINE

1.98 kg

# JETT-R 106.930.MF

## JETT-R 106.930.MF

Jett Evo | Recessed (1xLED 52W 930/3000K 6360lm 26°)

— C0/C180    cd / 1000 lm

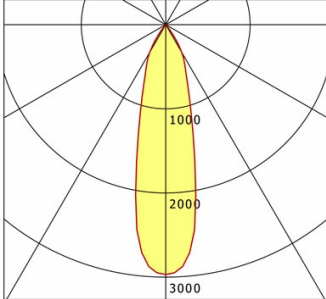

	C0	C90	C180	C270
0°	2969	2969	2969	2969
15°	1209	1209	1209	1209
30°	380	380	380	380
45°	18	18	18	18
60°	14	14	14	14
75°	6	6	6	6
90°	0	0	0	0
cd / 1000 lm				

Offset [m]    Cone width [m]    Illuminance [lx]

C0-C180 Plane		
3.0	1.40	2098.1
6.0	2.79	524.5
9.0	4.19	233.1
12.0	5.59	131.1
15.0	6.99	83.9

<b>η</b>	LED
Efficiency	123 lm/W
Direct/Indirect	↓ 100% / ↑ 0%
System Power	52 W
<b>UGR</b>	X=4H, Y=8H
Reflection factors	70/50/20
UGR C0/C180	23.3
UGR C90/C270	23.3
CIE Flux Codes	96 98 99 100 100
Ra/CRI	>90

LTS

## Accessories



**FOCUS 100.1**  
superior optic with focusable biconvex lens for  
accent lighting



**ZBK 96**  
anti-glare flaps



**ZBW 83**  
honeycomb louvre



**ZDAR 158.200-265**  
compensation ring for ceiling cut-outs from 200 to  
265 mm



**ZDVR 0157**  
ceiling reinforcement ring