

JETT-R 106.940.MF/DALI

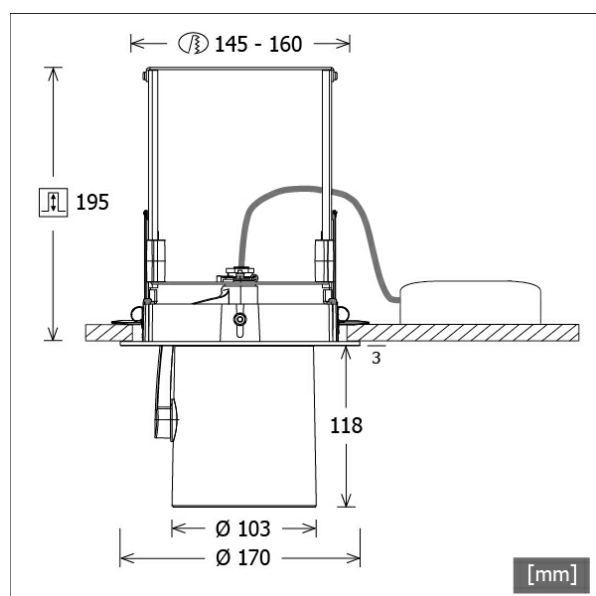

Colours	Article no.	EAN
silver	669569	4043544812407
black	669570	4043544812414
white	669571	4043544812421



Description

- flexible recessed spotlight with cylindrical light-head
- light-head completely extracts, rotates through 355° and pivots through 90°
- outstanding ease of maintenance
- no UV and thermal emissions
- light-head made from die-cast aluminium
- innovative thermal management with design-integrated passive cooling
- specular aluminium reflector with precise symmetrical beam characteristic for high luminous efficiency and glare-free lighting
- recessed frame made from aluminium and sheet steel
- concealing plate for ceiling opening
- clear safety glass
- tool-free ceiling mounting via automatic quick clamping (automatic adjustment of the ceiling thickness)
- luminaire and ballast permanently connected via cable (length: 500 mm), ballast ready for mains connection
- ballast (LED converter DALI, dimmable) included (external placement)

Notes

Luminaire must only be used in open ceiling systems.

Standard options

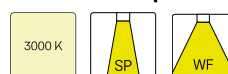

Special options



Lighting data / Norms

Lamps	LED Spot / CRI 90 / 4000 K
Lifetime	L90 B50 50.000 h L80 B50 100.000 h L80 B20 50.000 h
System power	52.1 W
Luminaire luminous flux	6330 lm
System efficiency	121.49 lm/W
Module efficiency	141.00 lm/W
UGR class	≤25
Beam range	Medium Flood
Beam angle	26°
Supply voltage	220 - 240 V / 50 - 60 Hz
Protection class	II
Type of protection	IP20

Dimensions / Weights

Outer diameter	170 mm
Height	198 mm
Cut-out (Ø)	145 mm
Ceiling thickness	5.0 - 50.0 mm
Recessed depth	195 mm
Diameter of light head	103 mm
Net weight	1.89 kg

Recessed Spotlights · Jett Evo Recessed

JETT-R 106.940.MF/DALI

Gross weight



LTS
LOVE TO SHINE

1.99 kg

JETT-R 106.940.MF/DALI

JETT-R 106.940.MF/DALI

Jett Evo | Recessed (1xLED 52W 940/4000K 6490lm 26°)

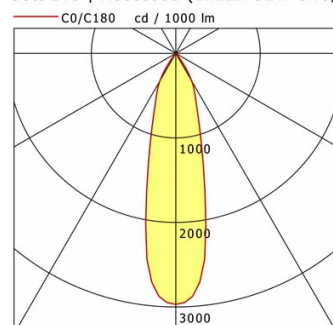

	C0	C90	C180	C270
0°	2969	2969	2969	2969
15°	1209	1209	1209	1209
30°	380	380	380	380
45°	18	18	18	18
60°	14	14	14	14
75°	6	6	6	6
90°	0	0	0	0
cd / 1000 lm				

Offset [m]	Cone width [m]	Illuminance [lx]
3.0	1.40	2141.0
6.0	2.79	535.2
9.0	4.19	237.9
12.0	5.59	133.8
15.0	6.99	85.6

η	LED
Efficiency	125 lm/W
Direct/Indirect	↓ 100% / ↑ 0%
System Power	52 W
UGR	X=4H, Y=8H
Reflection factors	70/50/20
UGR C0/C180	23.4
UGR C90/C270	23.4
CIE Flux Codes	96 98 99 100 100
Ra/CRI	> 90

LTS

Accessories



FOCUS 100.1
superior optic with focusable biconvex lens for accent lighting



ZB-OR DONGLE
Organic Response IR dongle kit



ZB-OR GATEWAY
Organic Response IoT Gateway Cascade Series



ZB-OR-R SENSOR
Organic Response sensor for recessed mounting



ZBK 96
anti-glare flaps



ZBW 83
honeycomb louvre



ZDAR 158.200-265
compensation ring for ceiling cut-outs from 200 to 265 mm

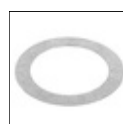

ZDVR 0157
ceiling reinforcement ring